

**APPLICATION FOR A MODIFICATION TO THE DEFINITIVE MAP AND STATEMENT  
Wildlife and Countryside Act 1981**

To: Surrey County Council  
Countryside Access  
Whitebeam Lodge  
Merrow Depot, Merrow Lane,  
Merrow Lane  
Guildford  
GU4 7BQ

I/We (i) **MARION MALCHER**

of (ii) **8 LINCOLN DRIVE, PYRFORD, WOKING, SURREY GU22 8RL**

hereby apply for an order under section 53(2) of the Wildlife and Countryside Act 1981 modifying the Definitive Map and Statement for the area by (iii):-

(a) **Deleting** the footpath/bridleway/restricted byway/byway open to all traffic\* which runs

from:

to:

(b) **Adding** the footpath/~~bridleway/restricted byway/byway open to all traffic\*~~ which runs

from: **PYRFORD COMMON (TQ 035589)**

to: **UPSHOT LANE (TQ 039592)**

(c) **Upgrading/downgrading** to a footpath/bridleway/restricted byway/byway open to all traffic\* the footpath/bridleway/byway open to all traffic which runs

from:

to:

(d) **Varying/adding** to the particulars relating to the footpath/bridleway/restricted byway/byway open to all traffic\*

from:

to:

by providing that

as shown on the map annexed hereto.

I/We attach copies of the following documentary evidence [including statements of witnesses] in support of this application:-

- *Extract from Ordnance Survey 1:25000 scale map TQ5 pub. 1956*
- (iv) - *25 Evidence Forms + 1 letter completed by claimants showing use of the route over a period from 1963 - 2016*

Signed:

Date:

*4th July 2016*

\* Delete as

# Wildlife and Countryside Act 1981 Schedule 14 application

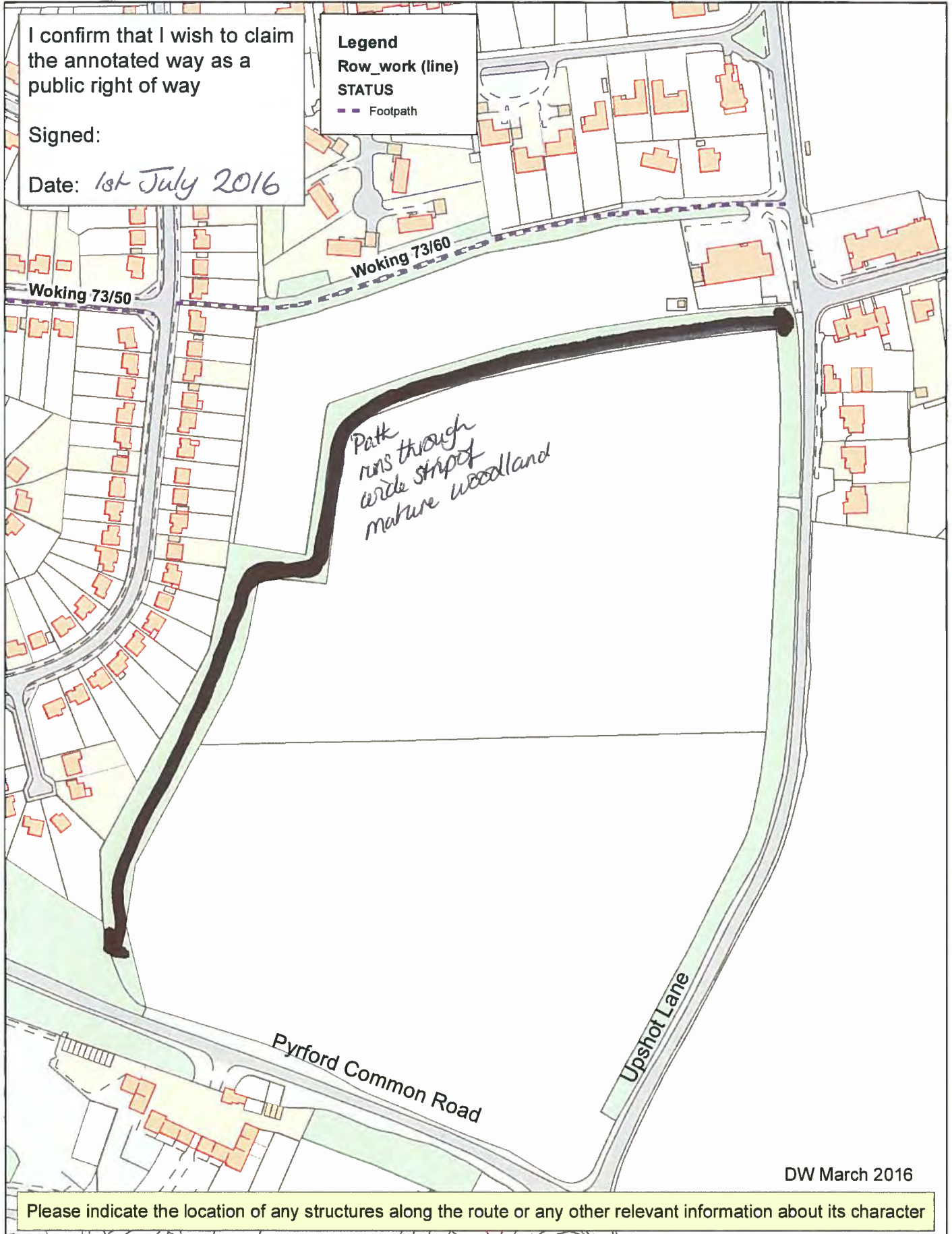

**Alleged public right of way between Upshot Lane (Woking) and Pyrford Common Road (Woking)**

1:2,500

© Crown Copyright and database rights 2014 Ordnance Survey 1000019813  
 Except A-Z Street Atlas © Copyright of the Publishers Geographers' A-Z Map Company Ltd

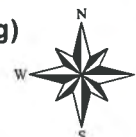

Please annotate ONE route with a dark coloured pen.