

KEY	
	Existing waiting, loading, and parking restrictions (may include symbols)
	Revocation of existing restrictions
	Proposed No Waiting Mon-Fri 8am-Noon

--

North Point

Scale: 1:500

Project Name	Elmbridge Parking Review 2024
Project Milestone	Proposed Traffic Order Amendments
Division	Walton South And Oatlands
Locality	Station Avenue - Walton

SURREY
COUNTY COUNCIL

OS terms & conditions: You are permitted to use this data solely to enable you to respond to, or interest with, the organisation that provided you with the data. You are not permitted to copy, re-broadcast, distribute or sell any of this data to third parties in any form.

Project No.	3282/ELM
Drawing No.	I15
Current Rev.	-
Phase	Advertisement

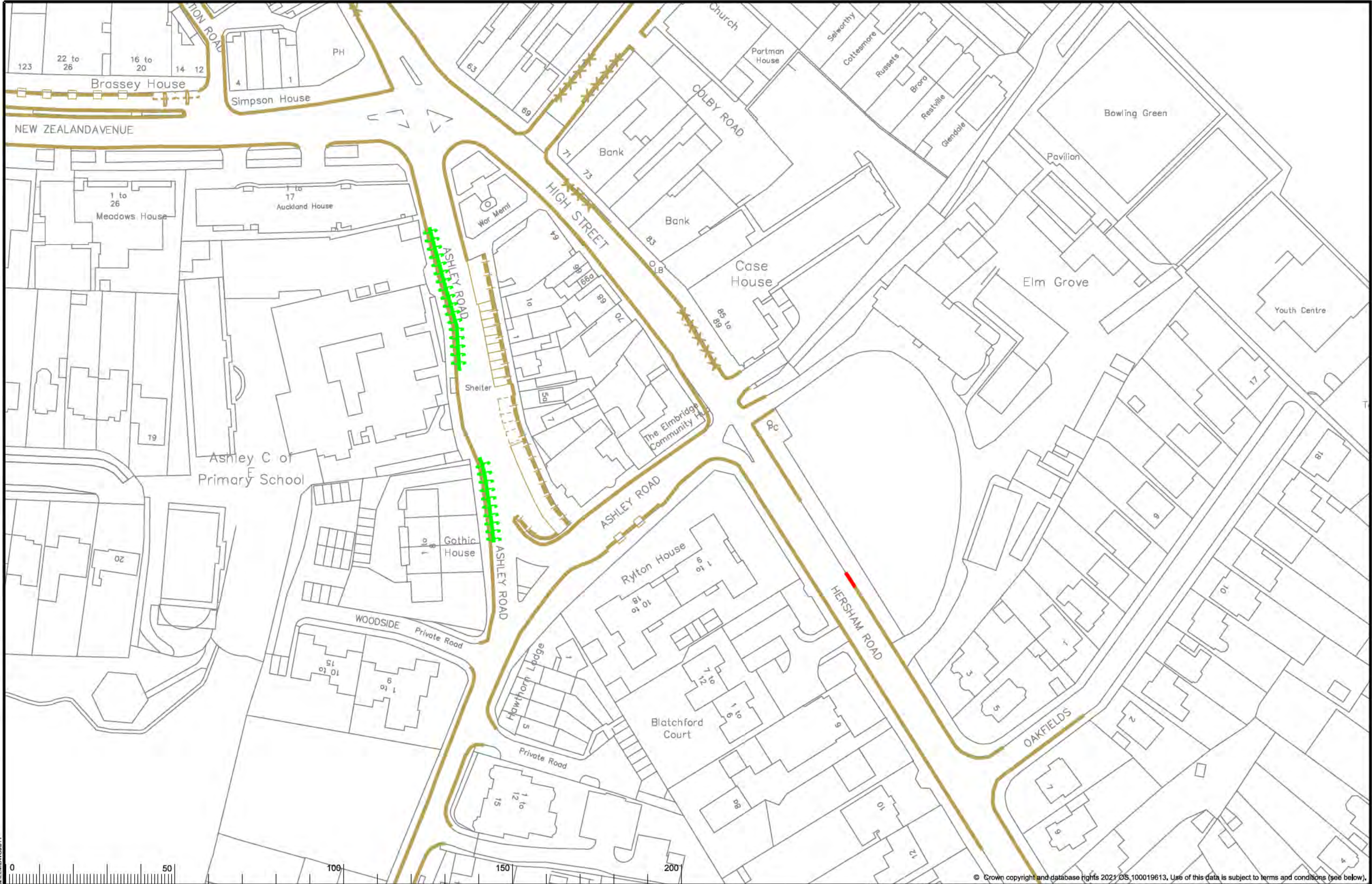

KEY Existing waiting, loading, and parking restrictions (may include symbols) Proposed No Waiting At Any Time Proposed No Stopping Mon-Fri 8am-5pm School Keep Clear		North Point Scale: 1:1000	Elmbridge Parking Review 2024 Proposed Traffic Order Amendments Walton South And Oatlands Hershham Road And Ashley Road	 SURREY COUNTY COUNCIL OS terms & conditions: You are permitted to use this data solely to enable you to respond to, or interact with, the organisation that provided you with this data. You are not permitted to copy, sub-license, distribute or sell any of this data to third parties in any form.	Project No. 3282/ELM Drawing No. J11 Current Flow - Phase Advertisement
--	--	------------------------------	--	--	--

File Name: S:\Project\Current\3282\ELM\DWG\J11

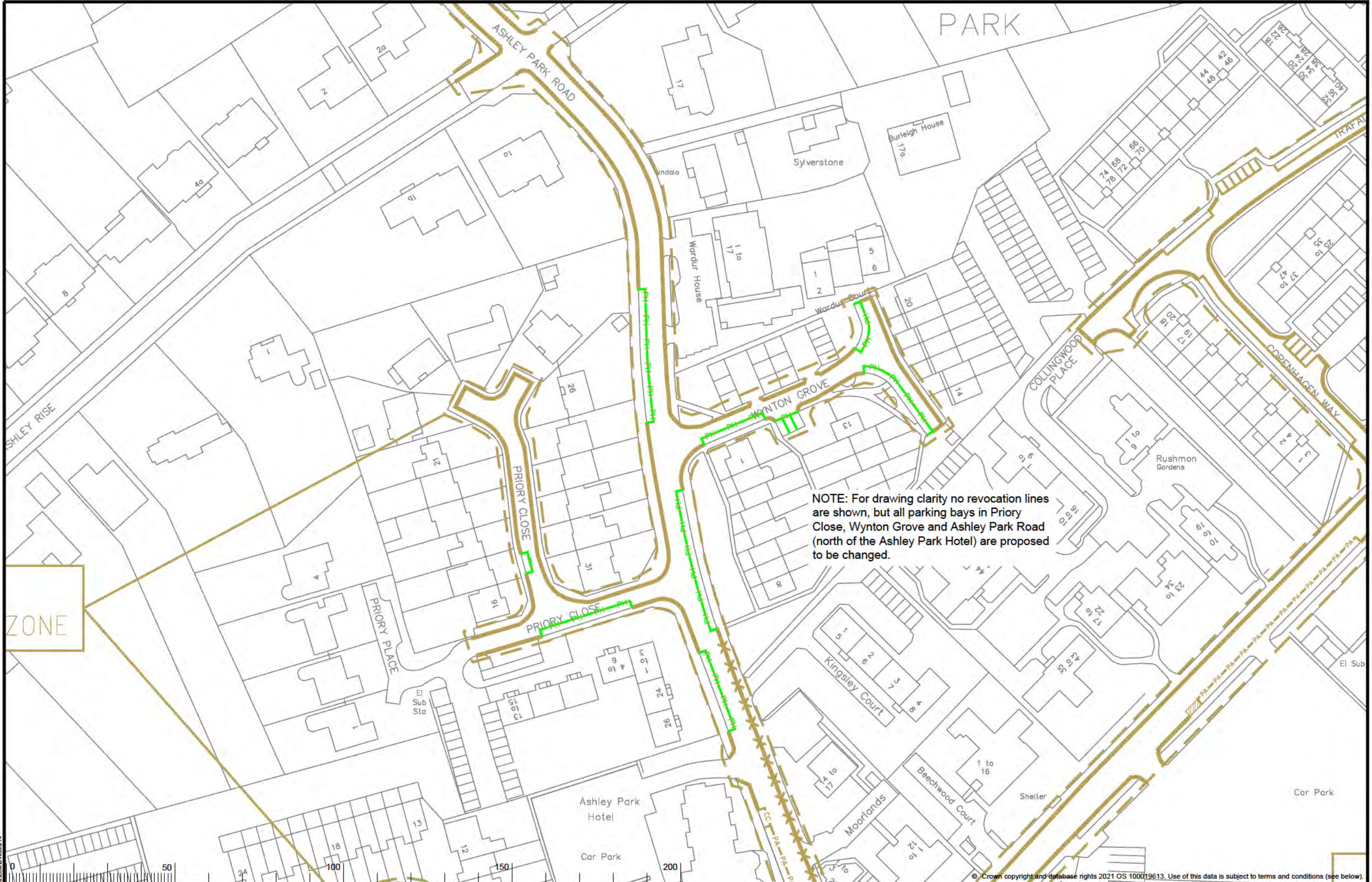

KEY — Existing waiting, loading or parking restrictions, may include symbols — PH — Proposed Parking Mon-Fri 8am-Noon Permit Holders (Walton CPZ) only		 Scale: 1:1000	Project Name Elmbridge Parking Review 2024	 <small>CC terms & conditions: You are permitted to use this data solely to enable you to respond to, or interact with, the organisation that provided you with this data. You are not permitted to copy, re-brand, distribute or sell any of this data to third parties in any form.</small>
			Project Milestone Proposed Traffic Order Amendments	
			Division Walton South And Oatlands	Drawing No. J14
			Locality Ashley Park Road, Priory Close, Wynton Grove	Current Rev. —
				Phase Advertisement

File Name: S:\Project-current\3282\ELM\DWG\J14

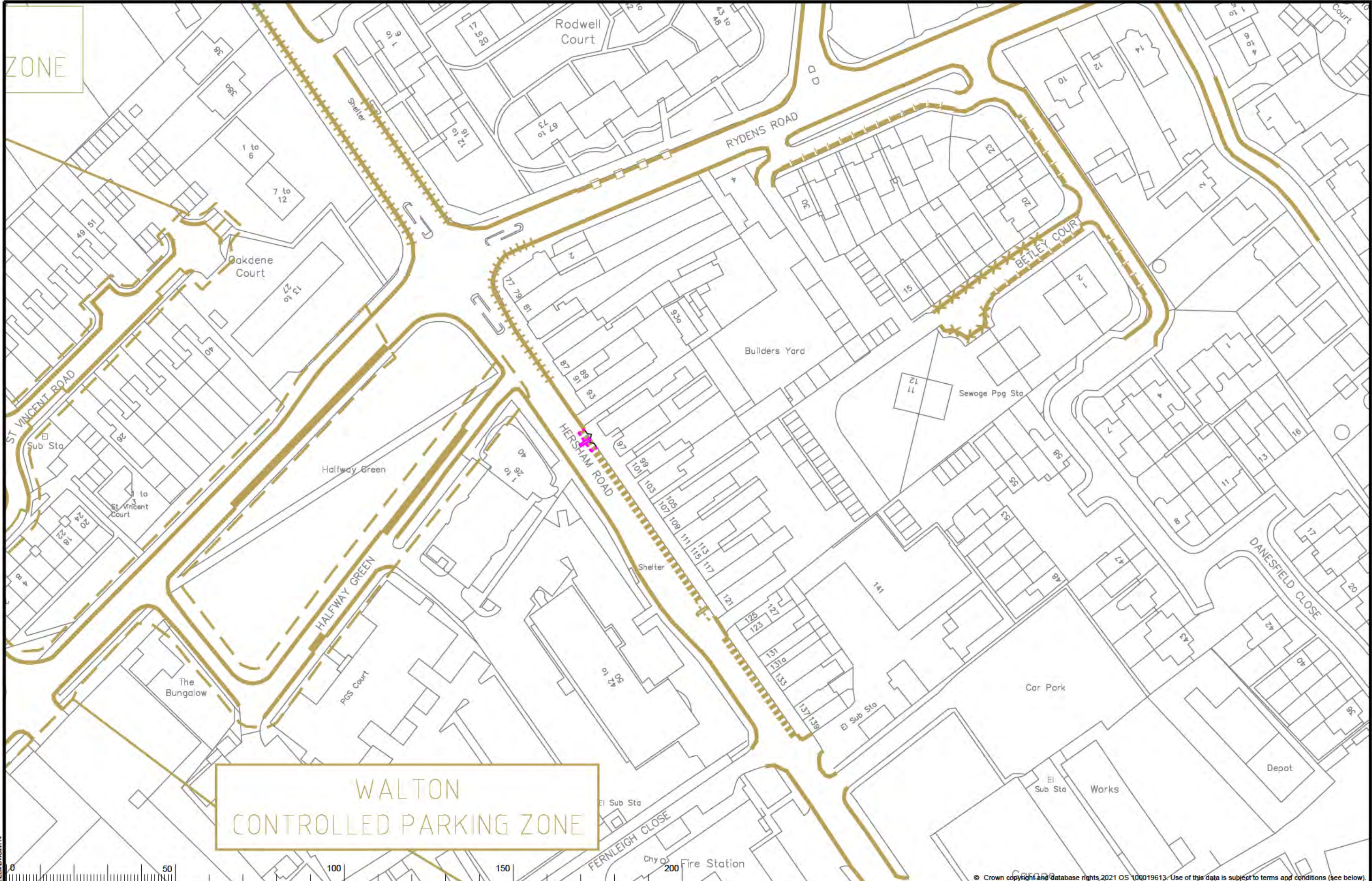

WALTON
CONTROLLED PARKING ZONE

- KEY**
- Existing waiting, loading, and parking restrictions (may include symbols)
 - Revocation of existing restrictions
 - Proposed Parking At Any Time Blue Badge Holders Only 3hrs No Return 1hr

North Point

Scale: 1:1000

Project Name: Elmbidge Parking Review 2024
Project Milestone: Proposed Traffic Order Amendments
Division:
Locality: Walton South And Oatlands
Hersham Road

SURREY
COUNTY COUNCIL

Project No: 3282/ELM
Drawing No: K14
Current Rev: -
Phase: Advertisement

File Name: S:\Project-current\3282\ELM\DWG\K14

© Crown copyright and database rights 2021 OS 100019613. Use of this data is subject to terms and conditions (see below).

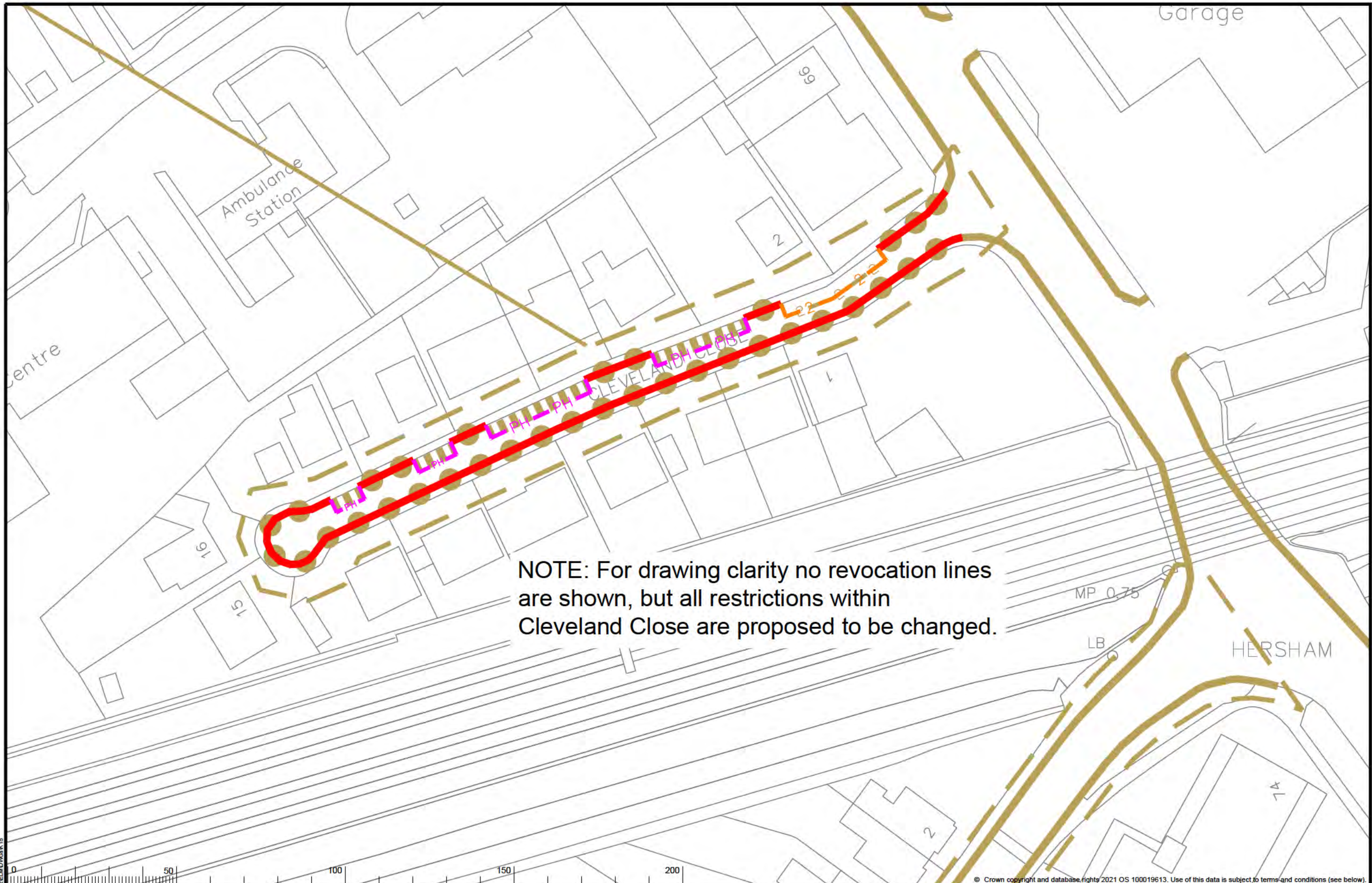

KEY Existing waiting, loading, and parking restrictions (may include symbols) Proposed No Waiting At Any Time Proposed Parking Mon-Fri 8am-6pm 2hrs No Return 2hrs Proposed Parking Mon-Fri 8am-6pm Permit Holders (J) Only		North Point Scale: 1:500	Project Name Elmbridge Parking Review 2024 Project Milestone Proposed Traffic Order Amendments Division Walton South And Oatlands Locality Cleveland Close - Walton	SURREY COUNTY COUNCIL © Crown copyright and database rights 2021 OS 100019613. Use of this data is subject to terms and conditions (see below). OS terms & conditions: You are permitted to use this data solely to enable you to respond to, or interact with, the organisation that provided you with the data. You are not permitted to copy, re-broadcast, distribute or sell any of the data to third parties in any form.	Project No. 3282/ELM Drawing No. K15 Current Rev. - Phase Advertisement
--	--	------------------------------------	--	--	--

File Name: S:\Project-current\3282\ELM\DWG\K15

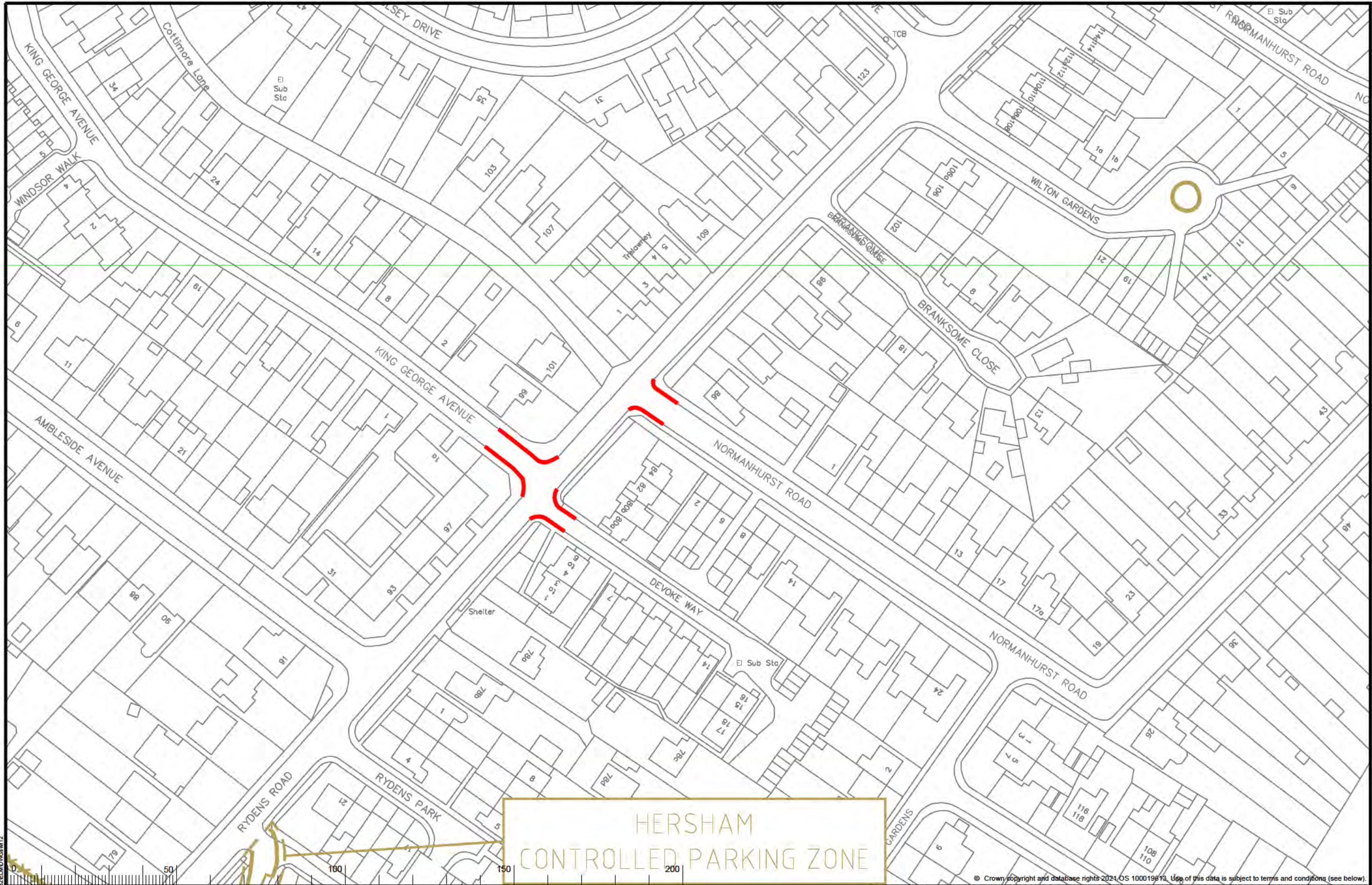

KEY	
	Existing waiting, loading, and parking restrictions (may include symbols)
	Proposed No Waiting At Any Time

HERSHAM CONTROLLED PARKING ZONE	
------------------------------------	--

 Scale: 1:1000	Project Name Elmbridge Parking Review 2024
	Project Milestone Proposed Traffic Order Amendments
	Division Walton / Walton South And Oatlands
	Locality King George Avenue, Normanhurst Road, Devoke Way

 © Crown copyright and database rights 2024. OS 100019813. Use of this data is subject to terms and conditions (see below).	Project No. 3282/ELM
	Drawing No. M12
	Current Rev. -
	Phase Advertisement

