

KEY

- PROPOSED NO WAITING AT ANY TIME
- EXISTING WAITING AND PARKING RESTRICTIONS

Notes

Rev.	Description	Drwn	Sig.	Date	Chkd	Sig.	Date	Appr.	Sig.	Date
A										



Based upon the Ordnance Survey mapping with permission of the Controller of Her Majesty's Stationery Office © Crown copyright. Unauthorised reproduction infringes Crown copyright and may lead to prosecution or civil proceedings. Surrey County Council LA 076072 2002

Drawn by AC Sig. AC Date 2024

Checked by originator AC Sig. AC Date 2023

Approved by DC Sig. DC Date 2023

Project TANDRIDGE DPE

Contract Sheet No. 3282/R&B

Drawing No. 18134 Rev. A

Classification ADVERTISED

Head of Engineering

18th, 19th, 20th Floor, 100, The Quadrant, Basingstoke, Hampshire, RG24 0AN

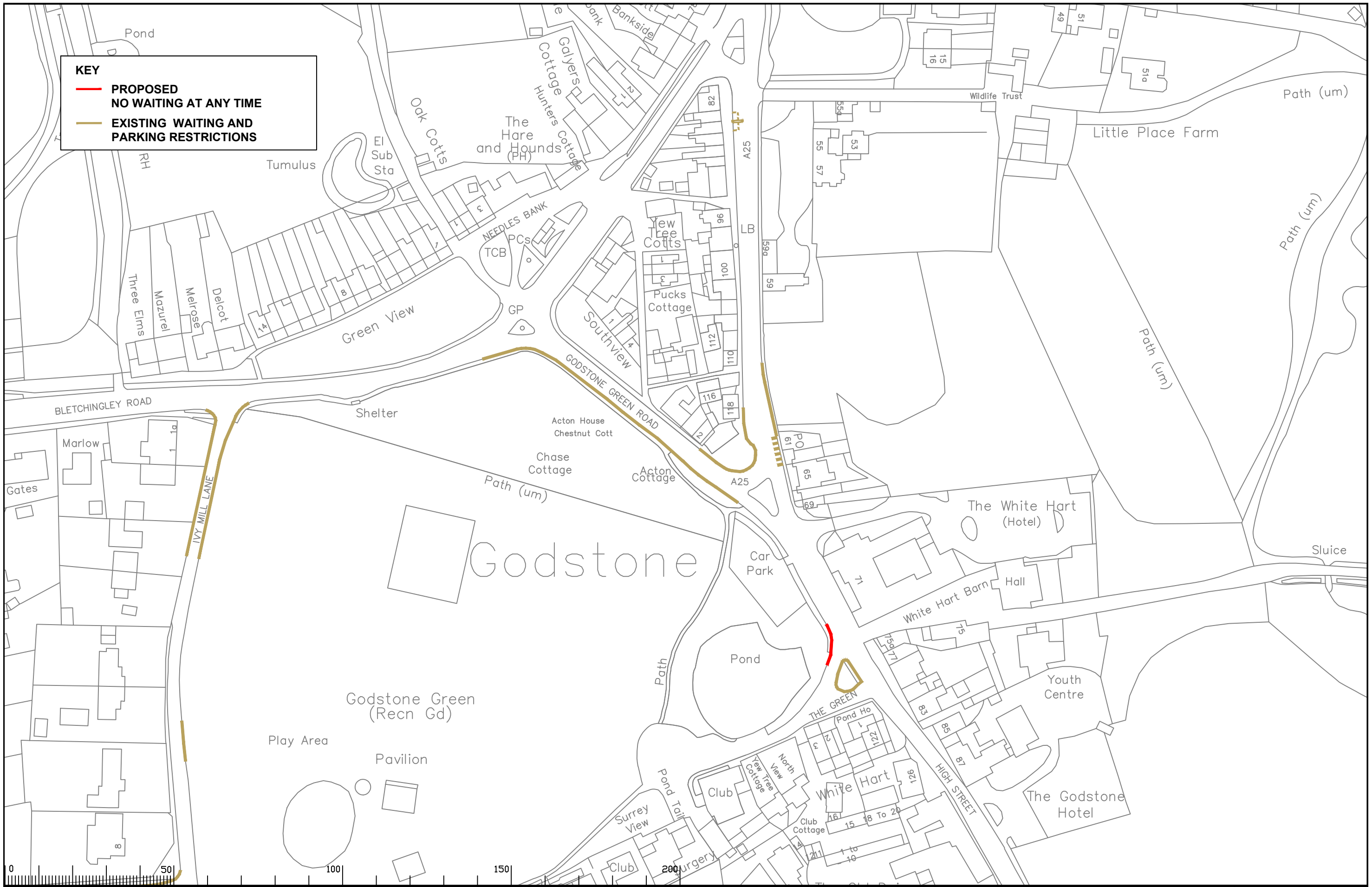

KEY

- PROPOSED NO WAITING AT ANY TIME
- EXISTING WAITING AND PARKING RESTRICTIONS

Notes

Rev.	Description	Drwn	Sig.	Date	Chkd	Sig.	Date	Appr.	Sig.	Date
A										

Rev.	Description	Drwn	Sig.	Date	Chkd	Sig.	Date	Appr.	Sig.	Date

North Point

Based upon the Ordnance Survey mapping with permission of the Controller of Her Majesty's Stationery Office. Crown copyright. Unauthorised reproduction infringes Crown copyright and may lead to prosecution or civil proceedings. Surrey County Council LA 076072 2002

Drawn by: AC, Sig: AC, Date: 2024
 Checked by originator: AC, Sig: AC, Date: 2023
 Approved by: DC, Sig: DC, Date: 2023

Project: TANDRIDGE DPE

IMPLEMNTED TRAFFIC ORDERS

SHEET OF

Project No. 3282/R&B

Contract Sheet No. 18092

Rev. A

Classification: ADVERTISED

SURREY COUNTY COUNCIL
 Head of Engineering
 Mr. Mike Stone

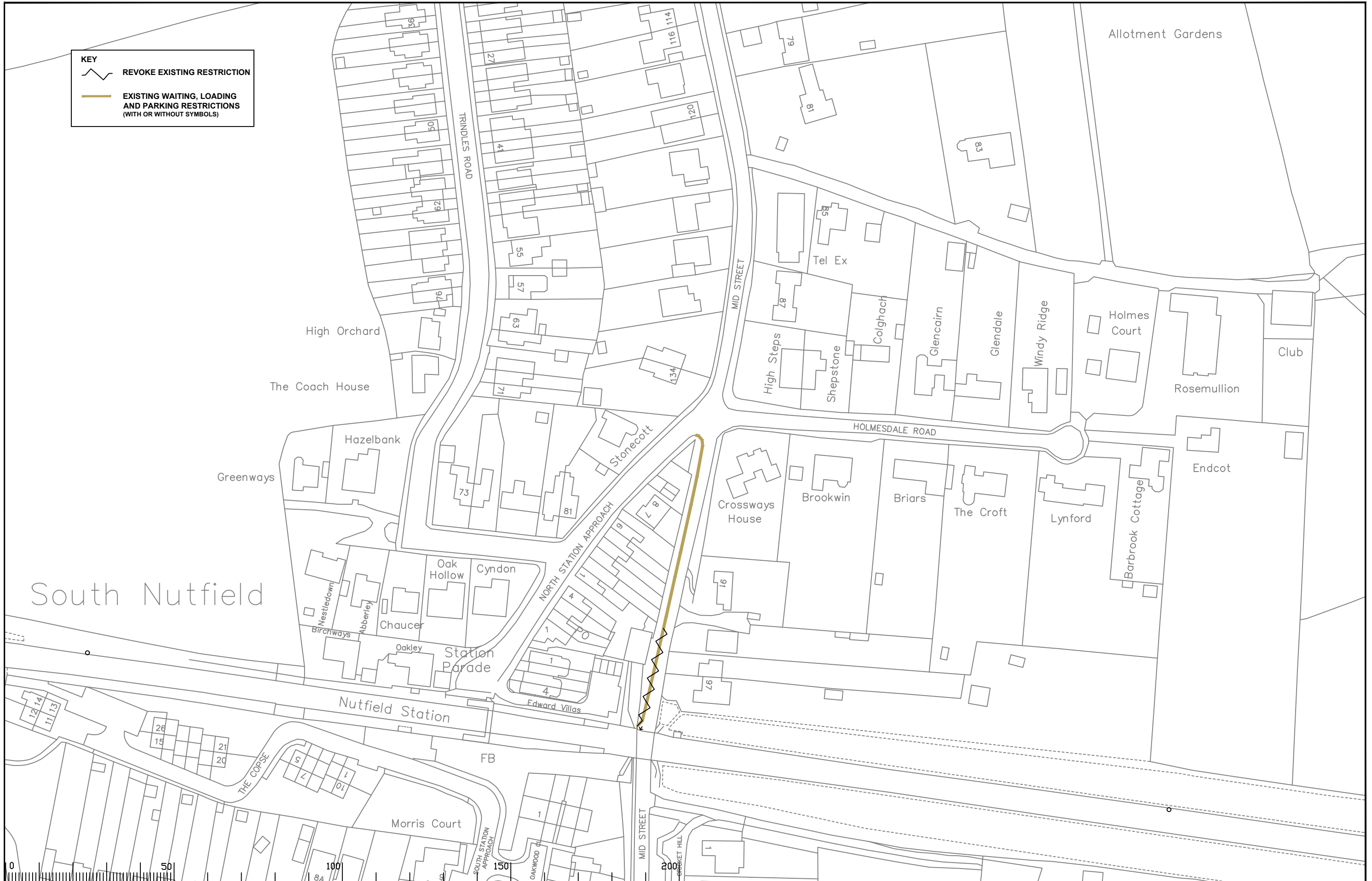

KEY
 ~~~~~ REVOKE EXISTING RESTRICTION  
 ————— EXISTING WAITING, LOADING AND PARKING RESTRICTIONS (WITH OR WITHOUT SYMBOLS)

Notes

| Rev. | Description | Drwn | Sig. | Date | Chkd | Sig. | Date | Appr. | Sig. | Date |
|------|-------------|------|------|------|------|------|------|-------|------|------|
| A    |             |      |      |      |      |      |      |       |      |      |
|      |             |      |      |      |      |      |      |       |      |      |
|      |             |      |      |      |      |      |      |       |      |      |

| Rev. | Description | Drwn | Sig. | Date | Chkd | Sig. | Date | Appr. | Sig. | Date |
|------|-------------|------|------|------|------|------|------|-------|------|------|
|      |             |      |      |      |      |      |      |       |      |      |
|      |             |      |      |      |      |      |      |       |      |      |

North Point

Based upon the Ordnance Survey mapping with permission of the Controller of Her Majesty's Stationery Office. © Crown copyright. Unauthorised reproduction infringes Crown copyright and may lead to prosecution or civil proceedings. Surrey County Council LA 076872 2003.

|             |    |      |    |      |      |
|-------------|----|------|----|------|------|
| Drawn by    | AC | Sig. | AC | Date | 2024 |
| Checked by  | AC | Sig. | AC | Date | 2023 |
| Approved by | DC | Sig. | DC | Date | 2023 |

Project  
**TANDRIDGE DPE**  
 Drawing  
**IMPLEMENTED TRAFFIC ORDERS**  
 SHEET 0F

**SURREY COUNTY COUNCIL**  
 Head of Engineering  
 280, High Street, Guildford, Surrey, GU1 2DG, UK

|                |            |
|----------------|------------|
| Project No.    | 3282/R&B   |
| Contract No.   | 18081      |
| Rev.           | A          |
| Classification | ADVERTISED |