

KEY	
	Existing waiting, loading or parking restrictions, may include symbols
	Proposed No Waiting At Any Time
	Proposed No Waiting Monday-Friday 8am-6pm

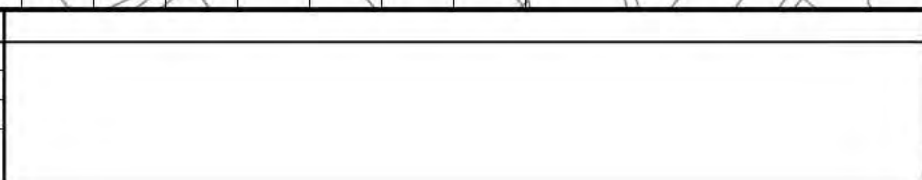

 Scale: 1:1250	Project Name <b>Elbridge Parking Review 2023</b>	 <small>© Crown copyright and database rights 2021 OS 100019613. Use of this data is subject to terms and conditions (see below).</small>	Project No. <b>3282/ELM</b>
	Project Milestone <b>Proposed Traffic Order Amendments</b>		Drawing No. <b>L29</b>
	City <b>Cobham</b>		Current Rev. -
	Location <b>Canada Road, Lockhart Road</b>		Phase <b>Final</b>

File Name: S:\Project-current\3282\ELM\DWG\L29



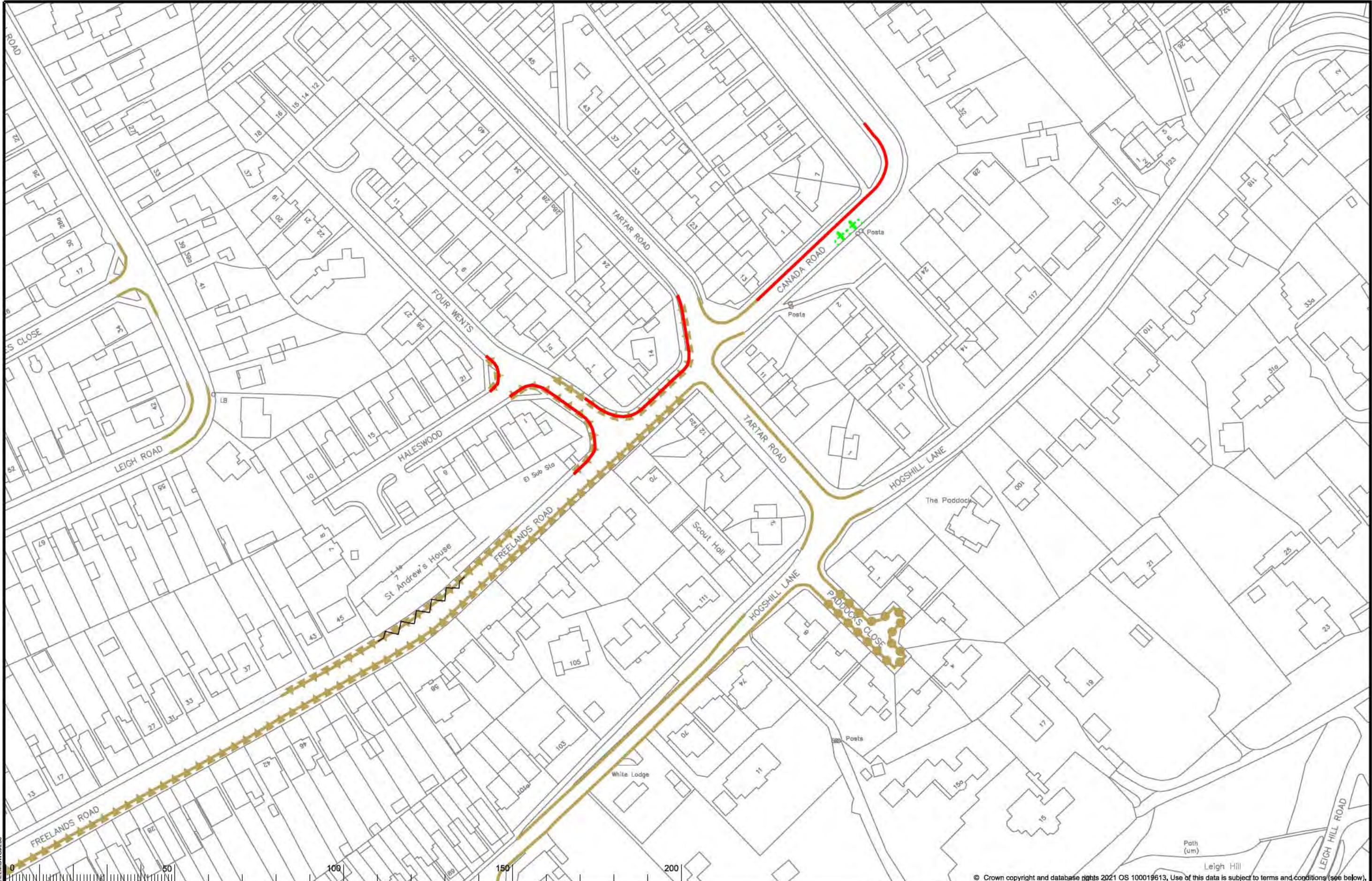

KEY	
	Existing waiting, loading or parking restrictions, may include symbols
	Proposed No Waiting At Any Time
	Proposed Parking At Any Time Blue Badge Holders Only

	Revocation of existing waiting, loading or parking restrictions
--	---

North Arrow

Scale: 1:1250

Project Name	Elmbridge Parking Review 2022-23
Project Milestone	Proposed Traffic Order Amendments
Division	Cobham - Freeland's Rd,
Locality	Tartar Rd, Haleswood, Four Wents, Canada Rd

© Crown copyright and database rights 2021 OS 100019613, Use of this data is subject to terms and conditions (see below).

Path (um)

Leigh Hill

Leigh Hill Road

SURREY COUNTY COUNCIL

OS terms & conditions: You are permitted to use this data solely to enable you to inspect, or interact with, the information that is provided to you with this data. You are not permitted to copy, sub-licence, distribute or sell any of this data to third parties in any form.

Project No.	3282/ELM
Drawing No.	L30
Current Rev.	-
Phase	Final

File Name: S:\Project\current\3282\ELM\DWG\l30.dwg



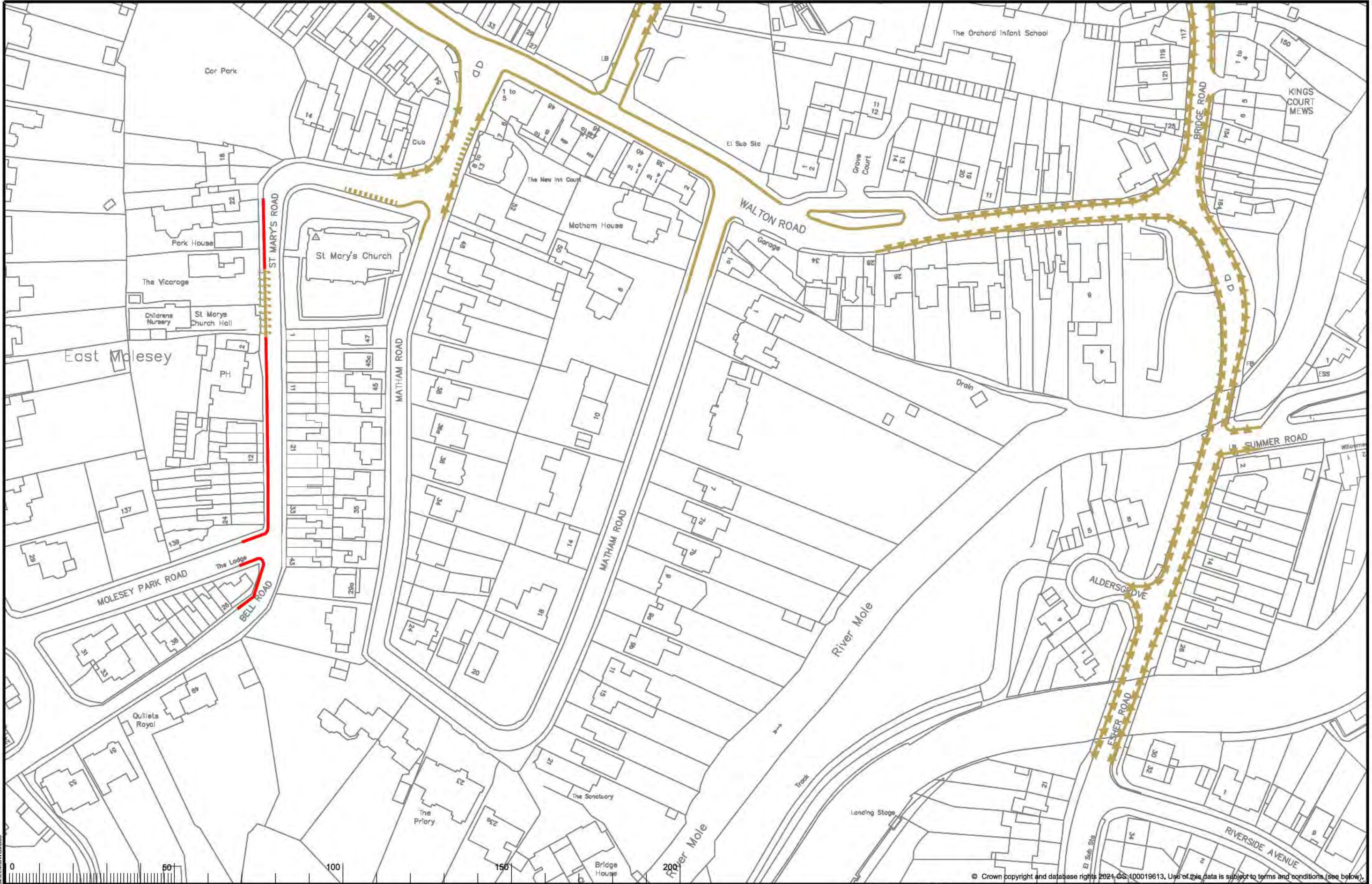

KEY	
	Existing waiting, loading or parking restrictions, may include symbols
	Proposed No Waiting At Any Time

North Point	Project Name	Elmbridge Parking Review 2023
	Project Milestone	Proposed Traffic Order Amendments
Scale: 1:1250	Division	East Molesey And Esher
	Locality	St Mary's Rd, Bell Rd, Molesey Pk Rd - East Molesey

	Project No.	3282/ELM
	Drawing No.	S06
	Current Rev.	-
	Phase	Final

File Name: S:\Project-current\3282\ELM\DWG\S06

© Crown copyright and database rights 2024. OS 100019613. Use of this data is subject to terms and conditions (see below).

On terms & conditions: You are permitted to use this data solely to enable you to respond to, or interact with, the organisation that provided you with the data. You are not permitted to copy, sub licence, distribute or sell any of this data to third parties in any form.



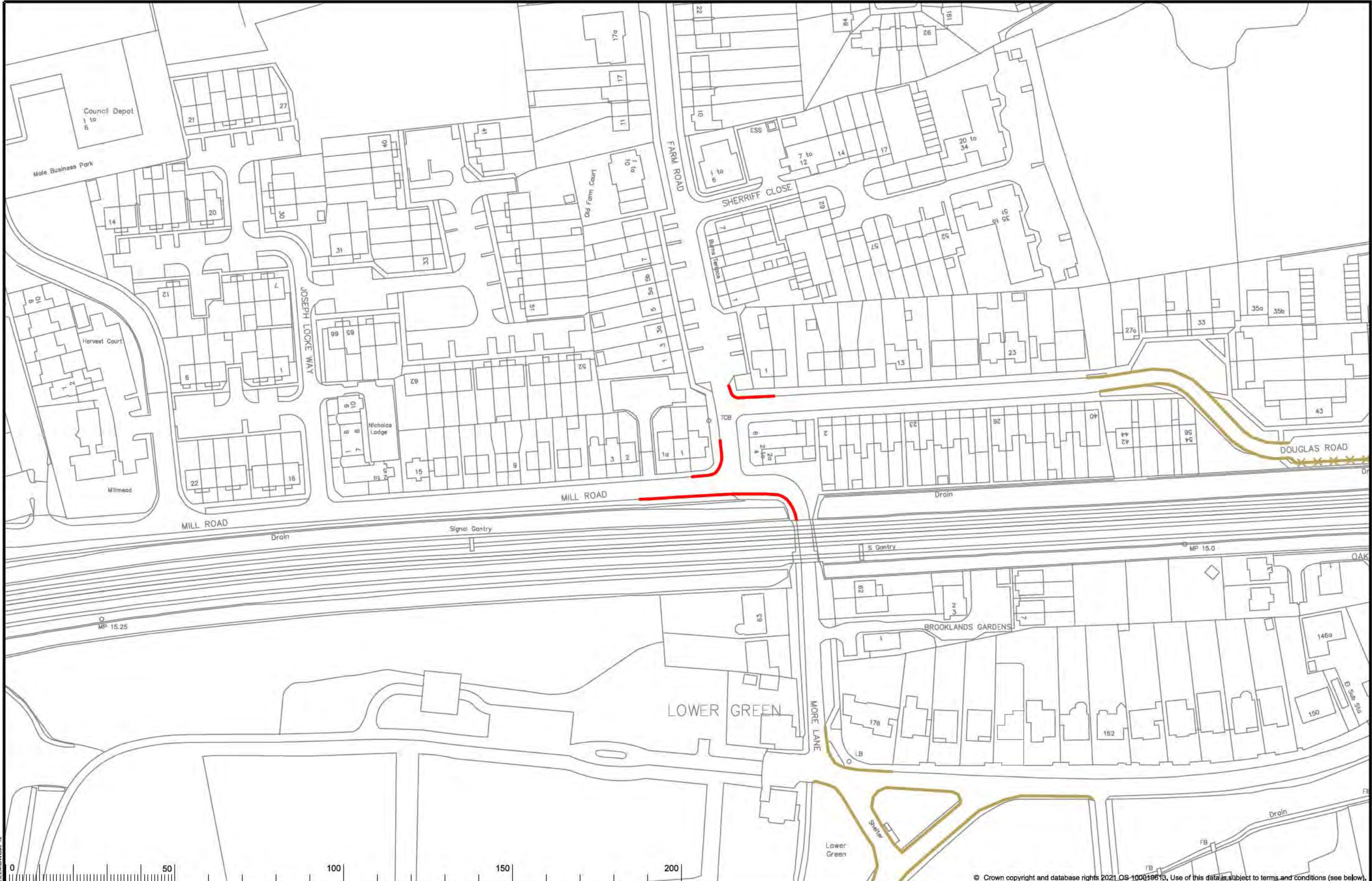

**KEY**

- Existing waiting, loading, and parking restrictions (may include symbols)
- Proposed No Waiting At Any Time

North Arrow

Scale: 1:1250

Project Name: Elmbridge Parking Review 2023  
Project Milestone: Proposed Traffic Order Amendments  
Division: East Molesey And Esher  
Locality: Mill Rd, Farm Rd, Douglas Rd - Esher

Project No: 3282/ELM  
Drawing No: P12  
Current Rev: -  
Phase: Final

**SURREY COUNCIL**

OS terms & conditions: You are permitted to use this data solely to enable you to respond to, or interact with, the organisation that provided you with the data. You are not permitted to copy, sub-licence, distribute or sell any of this data to third parties in any form.



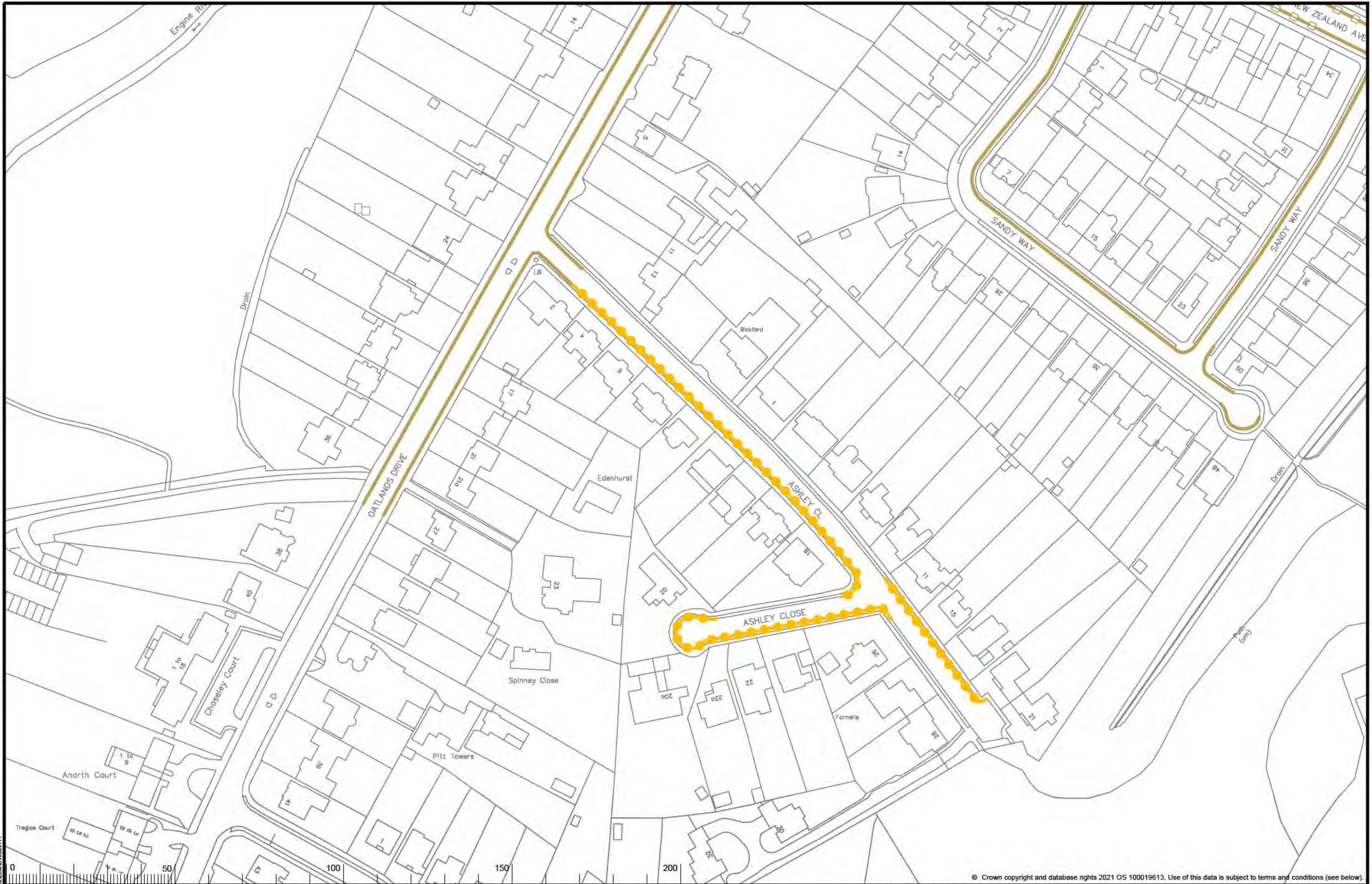

<b>KEY</b> Existing waiting, loading, and parking restrictions (may include symbols) Proposed No Waiting Monday - Friday 8am-6pm		 Scale: 1:1250	<b>Project Name</b> Elmbridge Parking Review 2022-23 <b>Project Milestone</b> Proposed Traffic Order Amendments	 <b>SURREY COUNTY COUNCIL</b> © Crown copyright and database rights 2021 OS 100019613. Use of this data is subject to terms and conditions (see below). On the map & don't see you a bit in the road to use in a data solely to enable you to expect the, a mile and in the, the a get set on that is no need you with the data. You a want the in road to copy, with a device, if at, but a well any of the data to the, if you it, in any to in.	<b>Project No.</b> 3282/ELM <b>Drawing No.</b> H11 <b>Current Rev.</b> - <b>Phase</b> Final
			<b>Location</b> Walton South And Oatlands Ashley Close, Walton		







