

**KEY**

- PROPOSED NO WAITING AT ANY TIME
- REVOKE EXISTING RESTRICTION
- PROPOSED NO STOPPING MON-SAT 8.15AM-6PM SCHOOL KEEP CLEAR
- EXISTING WAITING, LOADING AND PARKING RESTRICTIONS (WITH OR WITHOUT SYMBOLS)

Notes

Rev.	Description	Drwn	Sig.	Date	Chkd	Sig.	Date	Appr	Sig.	Date



Based upon the Ordnance Survey mapping with the permission of the Controller of Her Majesty's Stationary Office. © Crown copyright. Unauthorised reproduction infringes Crown copyright and may lead to prosecution or civil proceedings. Surrey County Council LA 076872 1998.

Drawn by	Sig.	Date
Checked by	Sig.	Date
Approved by	Sig.	Date

Project	Reigate and Banstead Parking Review 2024 to 25
Drawing	Rectory Lane, Woodmansterne Chipstead Valley Road, Chipstead

SHEET 01

**SURREY**  
COUNTY COUNCIL  
Sustainable Development  
Surrey Highways

Project No.	
Contract Sheet No.	
Drawing No.	178
Rev.	
Classification	ADVERT





Notes

Rev.	Description	Drwn	Sig.	Date	Chkd	Sig.	Date	Appr	Sig.	Date

File Name: \\00C2-FLS-08.surreycc.local\VOL4\MLABF3\ecdl\CORE\Traffic and Legal\Parking Team\REIGATE & BANSTEAD\2024 Review\RD19Review 2024.dwg

©A3

Based upon the Ordnance Survey mapping with the permission of the Controller of Her Majesty's Stationary Office. © Crown copyright. Unauthorised reproduction infringes Crown copyright and may lead to prosecution or civil proceedings. Surrey County Council LA 076873 1998.

Drawn by	Sig.	Date

Checked by	Sig.	Date

Approved by	Sig.	Date

Project: Reigate and Banstead Parking Review 2024 to 25

Drawing: Chipstead Way, Chipstead

**SURREY**  
COUNTY COUNCIL  
Sustainable Development  
Surrey Highways

Project No.	Contract Sheet No.	Drawing No.	Rev.	Classification
		15		ADVERT

SHEET 01



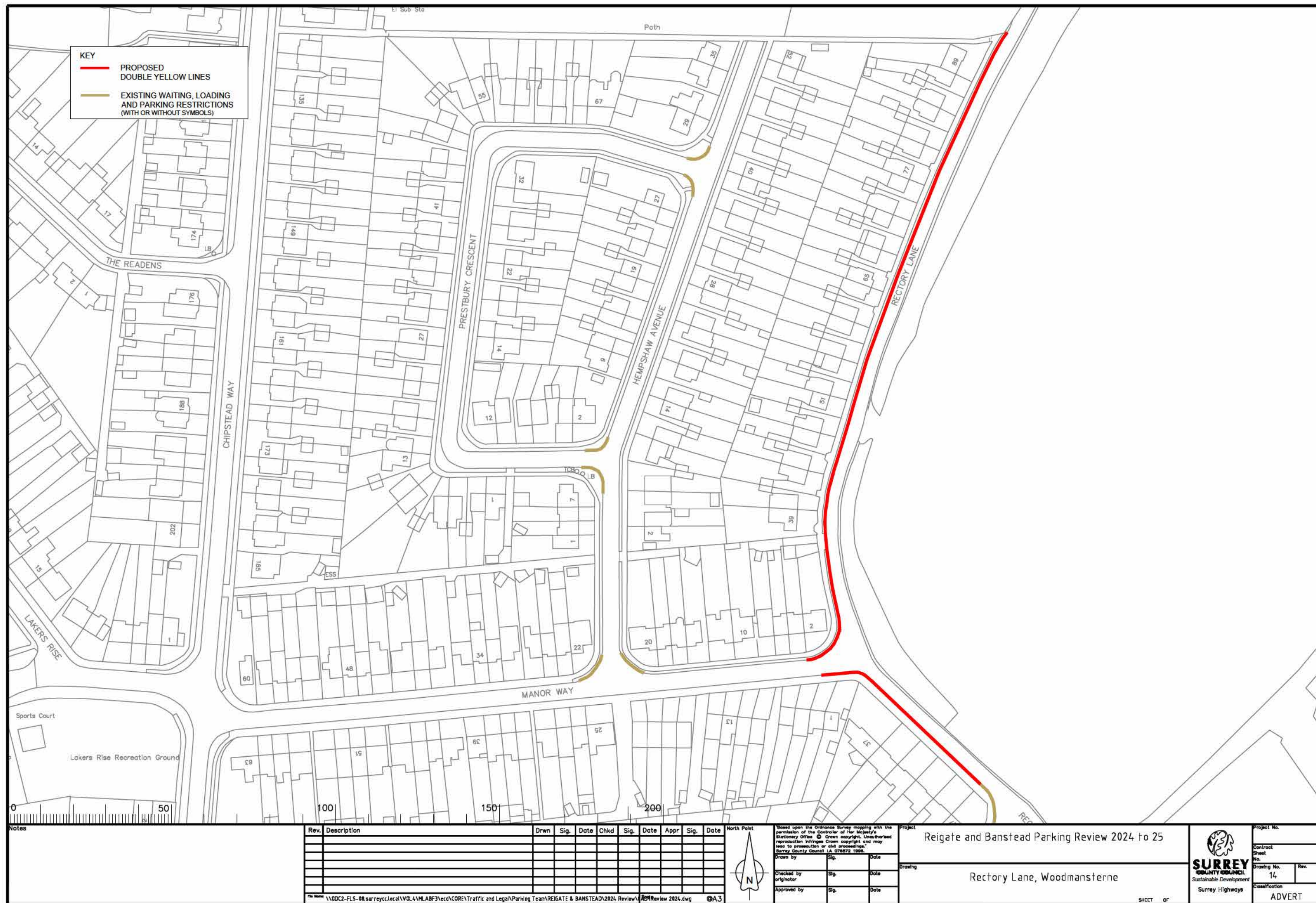



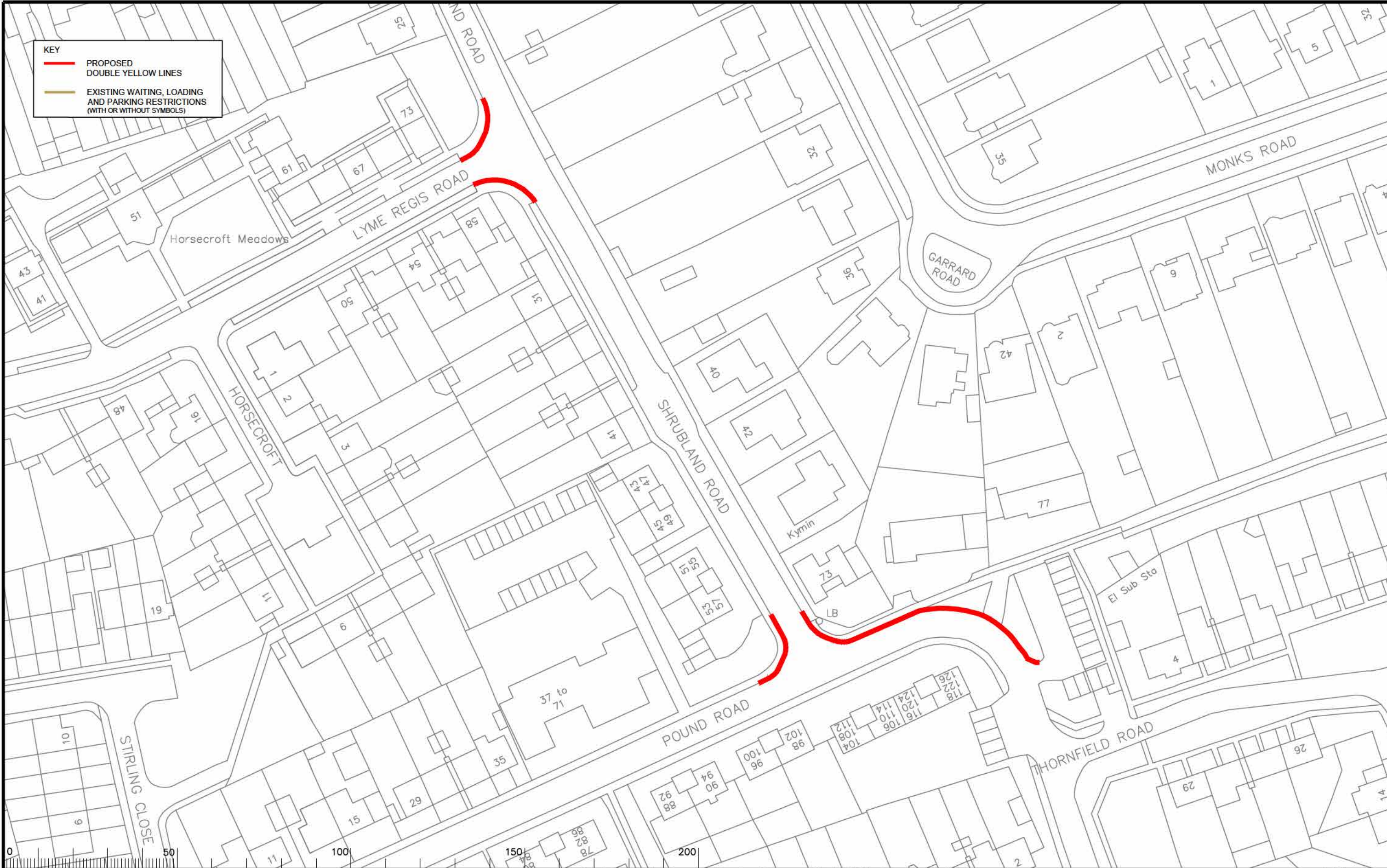

**KEY**

- PROPOSED DOUBLE YELLOW LINES
- EXISTING WAITING, LOADING AND PARKING RESTRICTIONS (WITH OR WITHOUT SYMBOLS)

Notes

Rev.	Description	Drwn	Sig.	Date	Chkd	Sig.	Date	Appr	Sig.	Date



Based upon the Ordnance Survey mapping with the permission of the Controller of Her Majesty's Stationary Office. © Crown copyright. Unauthorised reproduction infringes Crown copyright and may lead to prosecution or civil proceedings. Surrey County Council LA 076873 1998.

Drawn by	Sig.	Date
Checked by	Sig.	Date
Approved by	Sig.	Date

Project  
Reigate and Banstead Parking Review 2024 to 25

Drawing  
Pound Road j/w Shrubland Road, Banstead  
Shrubland Road j/w Lyme Regis Road, Banstead

SHEET 6F

**SURREY**  
COUNTY COUNCIL  
Sustainable Development  
Surrey Highways

Project No.	Contract Sheet No.	Drawing No.	Rev.
		216	

Classification  
ADVERT





**KEY**

- PROPOSED NO WAITING AT ANY TIME
- REVOKE EXISTING RESTRICTION
- EXISTING WAITING, LOADING AND PARKING RESTRICTIONS (WITH OR WITHOUT SYMBOLS)

Notes

Rev.	Description	Drwn	Sig.	Date	Chkd	Sig.	Date	Appr	Sig.	Date



Based upon the Ordnance Survey mapping with the permission of the Controller of Her Majesty's Stationary Office. © Crown copyright. Unauthorised reproduction infringes Crown copyright and may lead to prosecution or civil proceedings. Surrey County Council LA 076873 1998.

Drawn by	Sig.	Date
Checked by	Sig.	Date
Approved by	Sig.	Date

Project: Reigate and Banstead Parking Review 2024 to 25

Drawing: Wilmot Way, Banstead



Project No.	Contract Sheet No.	Rev.
	5	
Classification	ADVERT	

File Name: \\00C2-FLS-08.surreycc.local\\VOL4\\MLAB\\3\\ecol\\CORE\\Traffic and Legal\\Parking Team\\REIGATE & BANSTEAD\\2024 Review\\RD\\Review 2024.dwg

©A3

SHEET 01



