

KEY

	SECTION 278 BOUNDARY		ROAD SIGN (ILLUMINATED)
	EXISTING LINE MARKING		ANPR CAMERA
	PROPOSED WHITE LINE MARKING		STREET LIGHT
	PROPOSED YELLOW LINE MARKING		TRAFFIC SIGNAL
	ROAD SIGN		TRAFFIC SIGNAL CONTROLLER AND FEEDER PILLAR
	ROAD SIGN (EXISTING)		TRAFFIC BOLLARD (EXISTING)
	STREET LIGHT (EXISTING)		
	TRAFFIC BOLLARD		

CDM
 IN ADDITION TO THE HAZARDS/RISKS ASSOCIATED WITH THE TYPES OF WORK DETAILED ON THIS DRAWING, NOTE THE FOLLOWING:
 1. WORKS IN THE VICINITY OF LINE UNDERGROUND SERVICES WILL BE NECESSARY AND THE ADVICE OF ALL STATUTORY SERVICE COMPANIES MUST BE SOUGHT BEFORE ANY WORKS COMMENCE.
 2. WORKS ADJACENT TO NETWORK RAIL PROPERTY SHOULD BE CONDUCTED WITH APPROVAL FROM NETWORK RAIL.

SIGNS AND LINE MARKING
 SCALE 1:200

REV	DETAILS	DRAWN	CHECKED	DATE
A	AMENDMENTS FOLLOWING RS42	TW	PW	15.09.22
B	KEEP CLEAR ROAD MARKING ADJUSTED	JE	PW	14.10.22
C	MINOR AMENDMENTS	TW	PW	21.10.22
D	MINOR AMENDMENTS	AM	PW	02.11.22

NOTES

GENERAL

- FOR SITE PLAN, REFER DRG. VD15278-03-0100.
- FOR SIGNAGE DETAILS AND NOTES, REFER DRGS. VD15278-04-1210 AND VD15278-04-1211.
- FOR TRAFFIC SIGNALS REFER SIEMENS DRAWINGS AND NOTES 856340440.
- FOR HIGH FRICTION SURFACING, REFER DRGS. VD15278-08-0701 AND VD15278-08-0702.
- THE HIGHWAY AUTHORITY IS SURREY COUNTY COUNCIL (SCC).
- ALL INFRASTRUCTURE WORKS SHALL BE IN ACCORDANCE WITH SCC SPECIFICATIONS. WHERE THIS IS NOT RELEVANT, THE WORKS SHALL BE CONSTRUCTED IN ACCORDANCE WITH THE MANUAL OF CONTRACT DOCUMENTS FOR HIGHWAY WORKS VOLUME 1 - SPECIFICATION FOR HIGHWAY WORKS (SHW).
- BOUNDARIES SHOWN ARE INDICATIVE ONLY BASED ON STOPPING UP ORDERS AND SCC HIGHWAY BOUNDARIES.
- UPON COMPLETION OF THE WORKS, THE CONTRACTOR SHALL UNDERTAKE ALL NECESSARY MAINTENANCE REPAIRS TO RETURN THE HIGHWAY TO ITS FORMER CONDITION.
- THE HIGHWAY WORKS SHALL BE INSPECTED/SUPERVISED BY ON-SITE ENGINEER. PRIOR TO COMMENCING WORK THE CONTRACTOR SHALL PROVIDE A DETAILED CONSTRUCTION PROGRAMME.

SIGNS AND LINE MARKING

- ALL WORKS SHALL BE IN ACCORDANCE WITH THE TRAFFIC SIGNS REGULATIONS AND GENERAL DIRECTIONS 2016.
- ALL SCHEDULE REFERENCES ARE TO THE TRAFFIC SIGNS REGULATIONS AND GENERAL DIRECTIONS 2016.
- ALL SIGNS TO HAVE MINIMUM 2.3m CLEARANCE FROM GROUND TO THE BOTTOM OF THE SIGN PLATE.
- ALL SIGN POLES AND PLATES SHALL HAVE A MINIMUM LATERAL CLEARANCE OF 450mm FROM THE KERB FACE.
- ALL SIGNAGE ILLUMINATION SHALL USE LED LIGHTS AND SHALL BE LUA OR LUB FROM SIMMONS SIGNS OR APPROVED SIMILAR.
- ALL TRAFFIC BOLLARDS SHALL BE NON-ILLUMINATED RETROREFLECTIVE SELF-RIGHTING TYPE.
- ANPR CAMERAS AND SUPPORTING INFRASTRUCTURE TO BE CONTRACTOR DESIGNED. THEY ARE TO MEET THE REQUIREMENTS OF THE OPERATOR AND TO ACHIEVE DFT CERTIFICATION.
- CCTV FOUNDATIONS TO BE CONTRACTOR DESIGNED.
- LOCATIONS OF ALL SIGNS SHALL BE AGREED ON SITE WITH SURREY COUNTY COUNCIL ENGINEER PRIOR TO CONSTRUCTION.
- SUBJECT TO AGREED TRAFFIC REGULATION ORDER.

PROJECT
 WOKING TOWN CENTRE

DRAWING TITLE
 PHASE 8
 SIGNS AND LINE MARKING
 SHEET 2 OF 2

DRAWN TW **CHECKED** PW **DATE** 06.12.21 **SCALE AT A1** 1:200 @ A1 OR AS SHOWN

CLIENT
 WOKING BOROUGH COUNCIL

vectos.
 4th Floor Oxford Place, 61 Oxford Street, Manchester, M1 6EQ

CFI ISO 9001
UKAS 6125

DRAWING NUMBER VD15278-08-1202 **REVISION** D

NOTE: THE PROPERTY OF THIS DRAWING AND DESIGN IS VESTED IN VECTOS INFRASTRUCTURE LTD. IT MUST NOT BE COPIED OR REPRODUCED IN ANY WAY WITHOUT THEIR PRIOR WRITTEN CONSENT.

For Date: 03 Nov 2022 CAD File Name: L:\062015\VD15278\Working\Drawn\CDM\Vector\Infrastructure\Drawings\VD15278-08-1202.dwg

JOINS DRG. VD15278-08-1201

FOR APPROVAL

WORKING CONTROLLED
PARKING ZONE - Area 5

KEY

Double yellow lines 
No Waiting At Any Time

WORKING CONTROLLED
PARKING ZONE - Area 5

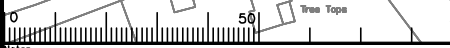
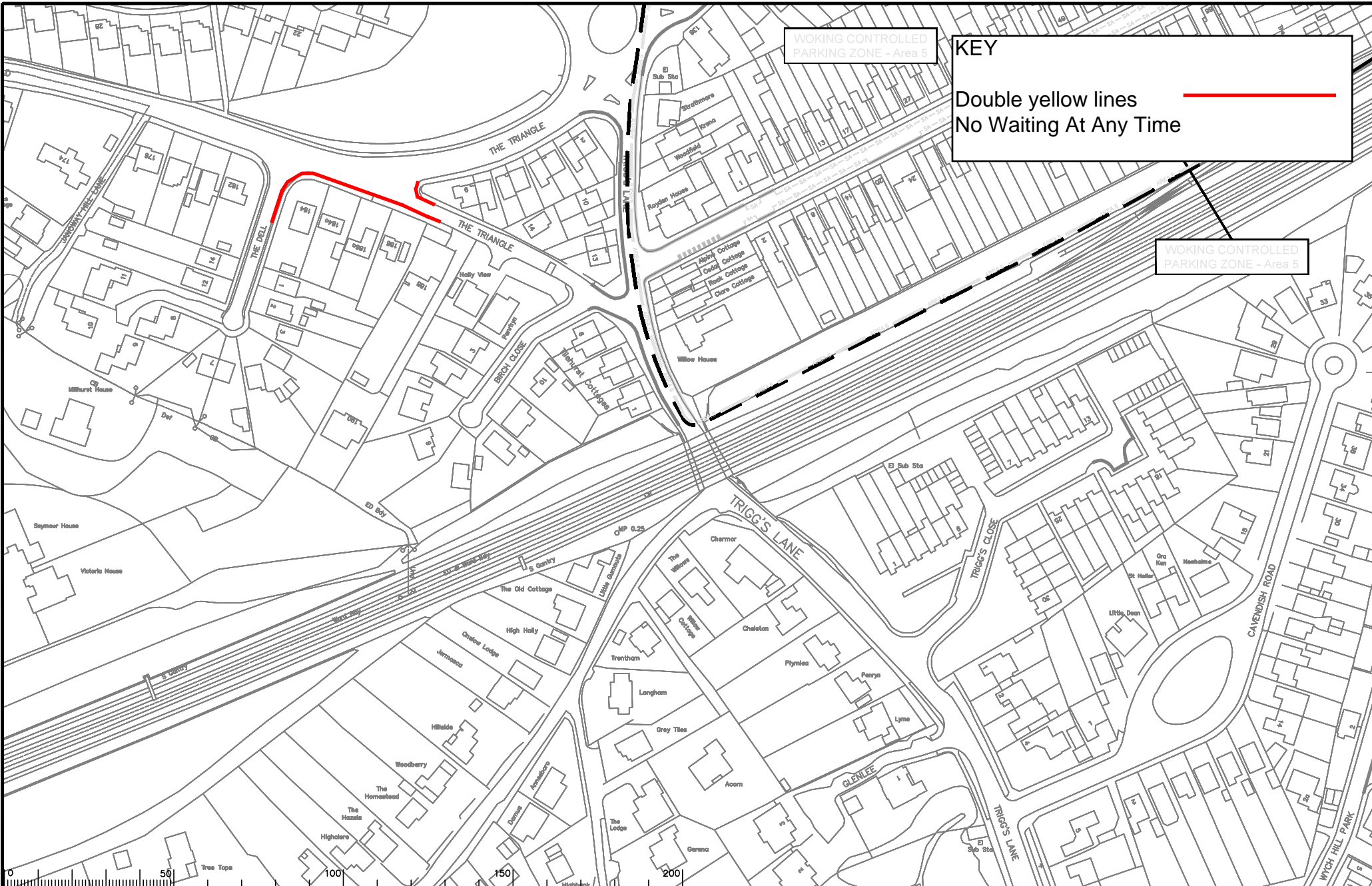

Drawing: GEH 05

Rev.	Description	Drawn	Sig.	Date	Chkd	Sig.	Date	Appr	Sig.	Date
A	RESTRICTIONS AMENDED	CAH	CAH	08.19	PW	PW	08.19	DC	DC	08.18
B	RESTRICTIONS AMENDED	RB	RB	08.22	PW	PW	08.22	DC	DC	08.22

Checked by	Sig.	Date	Checked by	Sig.	Date
CAH	CAH	05/19			
PW	PW	05/19			
RH	RH	05/19			



Based upon the Ordnance Survey mapping with the permission of the Controller of the Major's Stationery Office © Crown copyright. Unauthorised reproduction is prohibited. Green copyright not may lead to prosecution or civil proceedings.
Surrey County Council Ltd. 07872 1000

Drawn by: CAH, Date: 05/19
Checked by: PW, Date: 05/19
Approved by: RH, Date: 05/19

Project: WOKING DPE WOKING
Drawing: IMPLEMENTED TRAFFIC ORDERS



Project No: 3282/WOK
Contract No:
Drawing No: 20094 Rev: B
Classification: PROPOSAL