

KEY

EV PROPOSED ELECTRIC VEHICLE CHARGE POINTS AND ACCESSIBLE BAYS (NOT VISIBLE F UNDER PROPOSALS)

— EXISTING WAITING, LOADING AND PARKING RESTRICTIONS (WITH OR WITHOUT SYMBOLS)

Notes

| Rev. | Description | Drwn | Sig. | Date | Chkd | Sig. | Date | Appr | Sig. | Date | North Point |
|------|----------------------|------|------|-------|------|------|-------|------|------|-------|-------------|
| A | RESTRICTIONS AMENDED | CAH | CAH | 08.18 | PW | PW | 08.19 | DC | DC | 09.18 | |
| B | RESTRICTIONS REVISED | RB | RB | 01.22 | PW | PW | 01.22 | DC | DC | 01.22 | |
| | | | | | | | | | | | |
| | | | | | | | | | | | |
| | | | | | | | | | | | |

© \Users\yborlho\Desktop\3282 Parking Review 2022\3282 CAD EV Bay Locations\Dim Rd (PDR) 3282-2600#A.dwg

| Checked by | Sig. | Date |
|------------|------|-------|
| RB | RB | 01.22 |
| PW | PW | 01.22 |
| DC | DC | 01.22 |

| | |
|---|--|
| Project No. 3282/WCK | |
| Contract Sheet No. 20089 Rev. B | |
| Drawing No. 20089 Rev. B | |
| Description: WOKING DPE WOKING IMPLEMENTED TRAFFIC ORDERS | |
| Scale: 1:1 | |
| Sheet: 1 of 1 | |



WOKING CONTROLLED PARKING ZONE - Area 5

WOKING CONTROLLED PARKING ZONE - Area 5

WOKING CONTROLLED PARKING ZONE - Area 5

KEY

LEV PROPOSED ELECTRIC VEHICLE CHARGE POINTS AND ACCESSIBLE BAYS (NOT VISIBLE F UNDER PROPOSALS)

EXISTING WAITING, LOADING AND PARKING RESTRICTIONS (WITH OR WITHOUT SYMBOLS)

| Rev. | Description | Drawn | Sig. | Date | Chkd | Sig. | Date | Appr | Sig. | Date | North Point |
|------|----------------------|-------|------|-------|------|------|-------|------|------|-------|-------------|
| A | RESTRICTIONS AMENDED | CAJ | CAJ | 08.19 | PW | PW | 08.19 | DC | DC | 08.19 | |
| B | RESTRICTIONS REVISED | RB | RB | 01.22 | PW | PW | 01.22 | DC | DC | 01.22 | |

| Drawn by | Sig. | Date |
|-------------|------|-------|
| RB | RB | 01.22 |
| Checked by | Sig. | Date |
| RB | RB | 01.22 |
| Approved by | Sig. | Date |
| DC | DC | 01.22 |

Project: WOKING DPE WOKING

Project No.: 3282/WOK

Contract Sheet No.: 20092

Revision: B

Classification: PROPOSAL

Scale: 1:1000

Sheet: 1 of 1

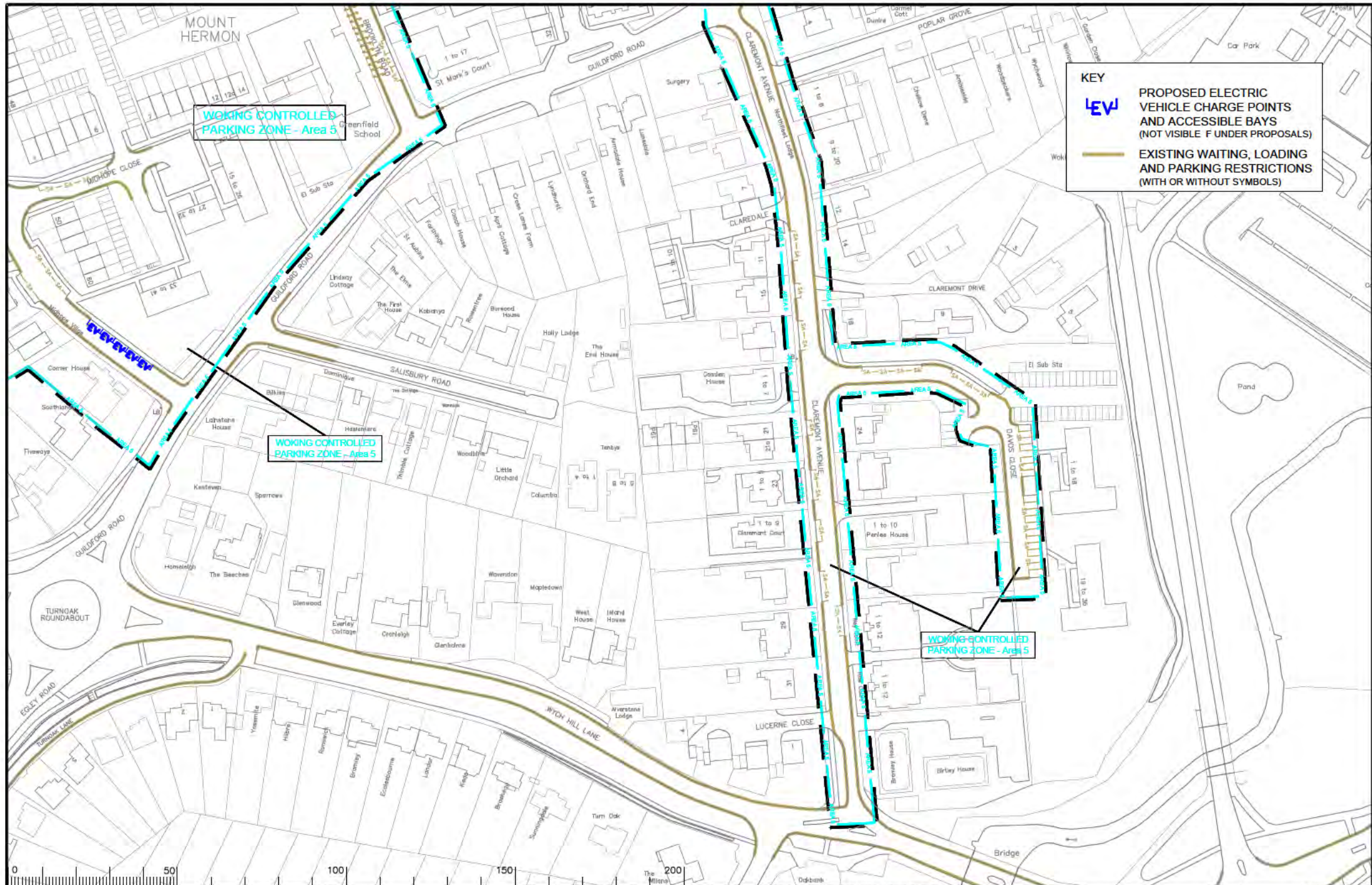

KEY

LEV PROPOSED ELECTRIC VEHICLE CHARGE POINTS AND ACCESSIBLE BAYS (NOT VISIBLE UNDER PROPOSALS)

EXISTING WAITING, LOADING AND PARKING RESTRICTIONS (WITH OR WITHOUT SYMBOLS)

Notes

| Rev | Description | Drwn | Sig | Date | Chkd | Sig | Date | Appr | Sig | Date |
|-----|----------------------|------|-----|-------|------|-----|-------|------|-----|-------|
| A | RESTRICTIONS AMENDED | CR | CR | 08.19 | PW | PW | 08.19 | DC | DC | 09.19 |
| B | RESTRICTIONS REVISED | RB | RB | 01.22 | PW | PW | 01.22 | DC | DC | 01.22 |

Scale

North Point

Based upon the Ordnance Survey mapping with the permission of the Controller of Her Majesty's Stationery Office. © Crown copyright. Unauthorised reproduction is prohibited. Ordnance Survey and may lead to prosecution or civil proceedings. © Crown Copyright. Licence No. 100027278.

| | | | | | |
|-------------|----|-----|----|------|-------|
| Drawn by | RB | Sig | RB | Date | 01.22 |
| Checked by | PW | Sig | PW | Date | 01.22 |
| Approved by | DC | Sig | DC | Date | 01.22 |

Project: WOKING DPE WOKING

Drawing: IMPLEMENTED TRAFFIC ORDERS

Project No: 3282/WOK

Sheet No: 20100

Rev: B

Classification: PROPOSAL

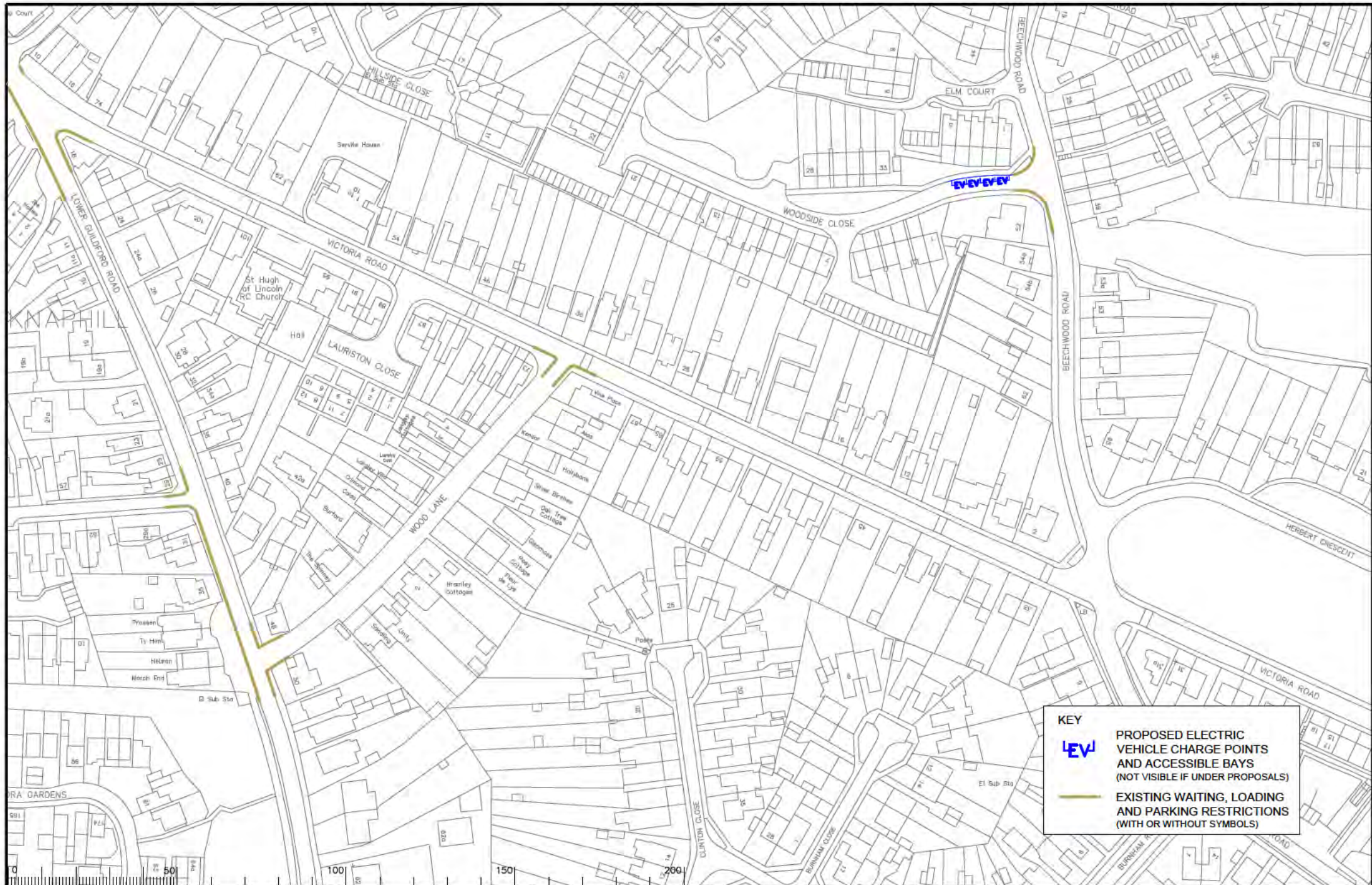

KEY

LEV PROPOSED ELECTRIC VEHICLE CHARGE BAYS AND ACCESSIBLE BAYS (NOT VISIBLE IF UNDER PROPOSALS)

EXISTING WAITING, LOADING AND PARKING RESTRICTIONS (WITH OR WITHOUT SYMBOLS)

Notes

| Rev | Description | Drwn | Sig. | Date | Chkd | Sig. | Date | Appr | Sig. | Date |
|-----|----------------------|------|------|-------|------|------|-------|------|------|-------|
| A | RESTRICTIONS AMENDED | CAH | CAH | 08.19 | PW | PW | 08.19 | DC | DC | 08.19 |
| B | RESTRICTIONS REVISED | RB | RB | 01.22 | PW | PW | 01.22 | DC | DC | 01.22 |
| | | | | | | | | | | |
| | | | | | | | | | | |
| | | | | | | | | | | |

| Drwn | Sig. | Date | Chkd | Sig. | Date | Appr | Sig. | Date |
|------|------|-------|------|------|-------|------|------|-------|
| CAH | CAH | 08.19 | PW | PW | 08.19 | DC | DC | 08.19 |
| RB | RB | 01.22 | PW | PW | 01.22 | DC | DC | 01.22 |
| | | | | | | | | |
| | | | | | | | | |
| | | | | | | | | |

Scale 1:250

North Point

Based upon the Ordnance Survey mapping with the permission of the Controller of Her Majesty's Stationery Office. © Crown copyright. Unauthorised reproduction infringes Crown copyright and may lead to prosecution or civil proceedings. Surrey County Council L.A. 200722 1000

Drawn by: RB, Date: 31.22

Checked by: PW, Date: 31.22

Approved by: DC, Date: 31.22

Project: KNAPHILL DPE WOKING

Drawing: IMPLEMENTED TRAFFIC ORDERS

Project No: 3282/WOK

Contract No: 20107

Rev: B

Classification: PROPOSAL

SHEET OF

SURREY COUNTY COUNCIL