

Key
— Double yellow lines - no waiting at any time

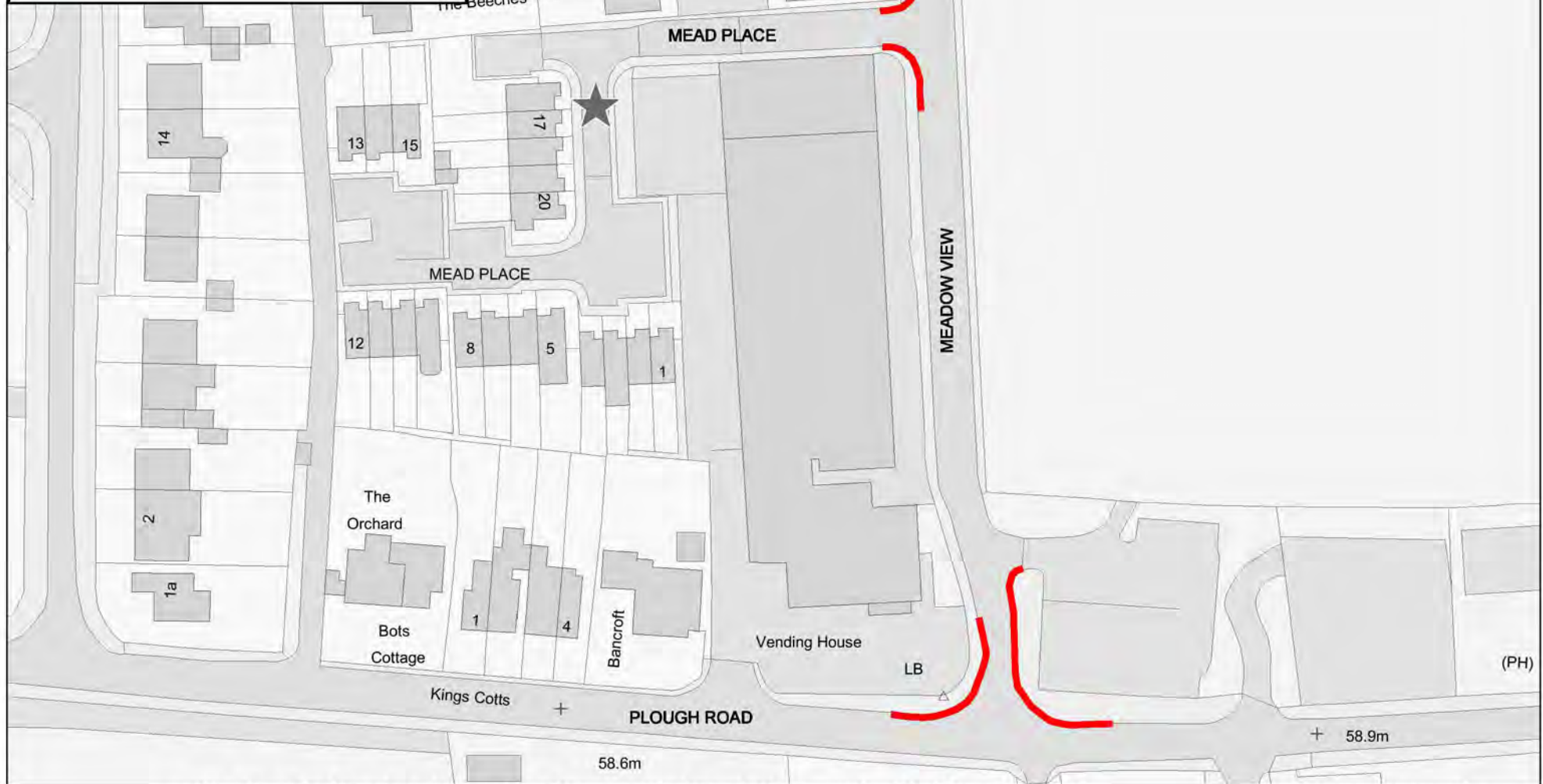

Smallfield- Meadow View, junctions with Mead Place and with Plough Road

**Drawing number:
31**

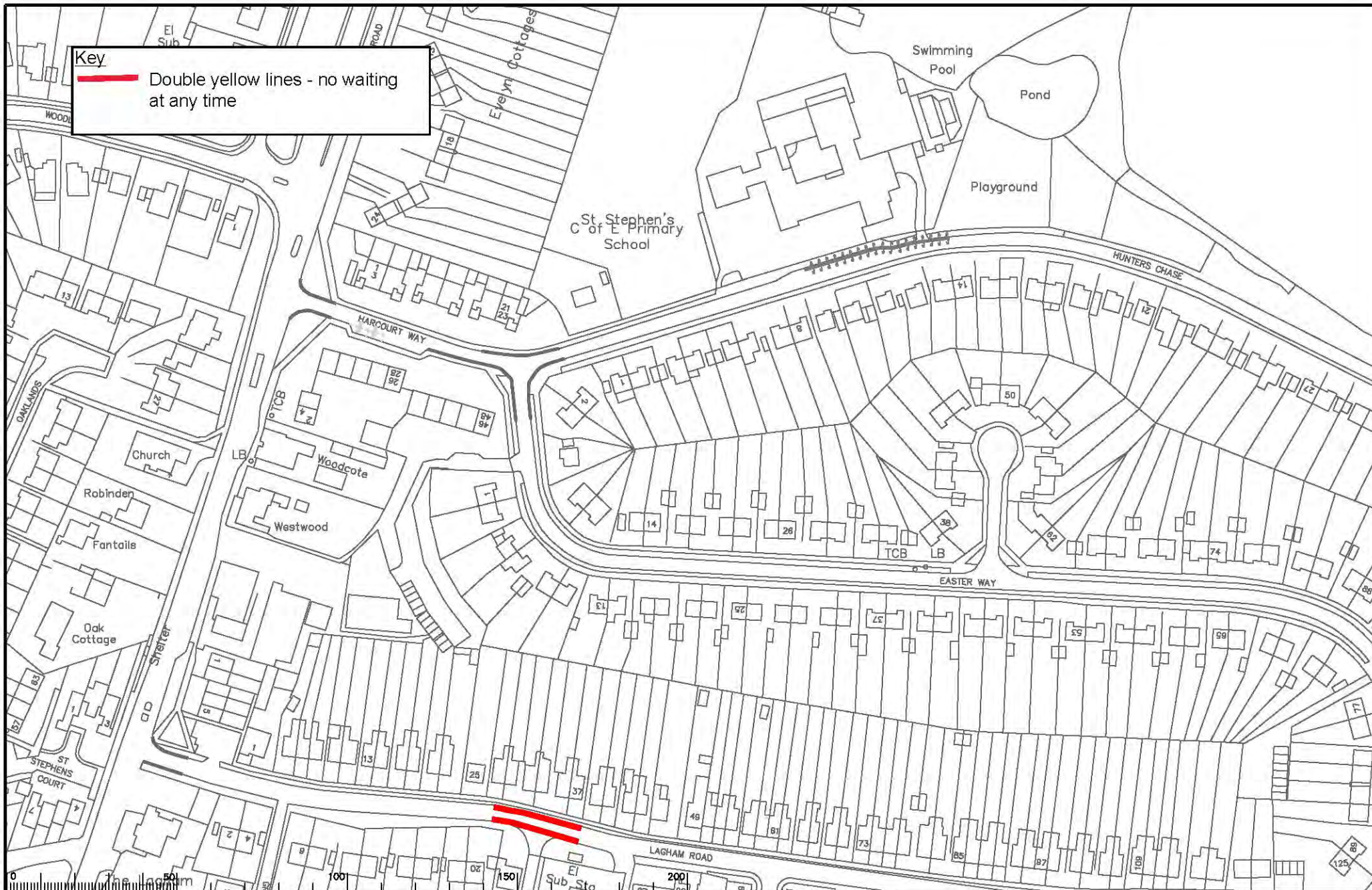

South Godstone - LAGHAM ROAD

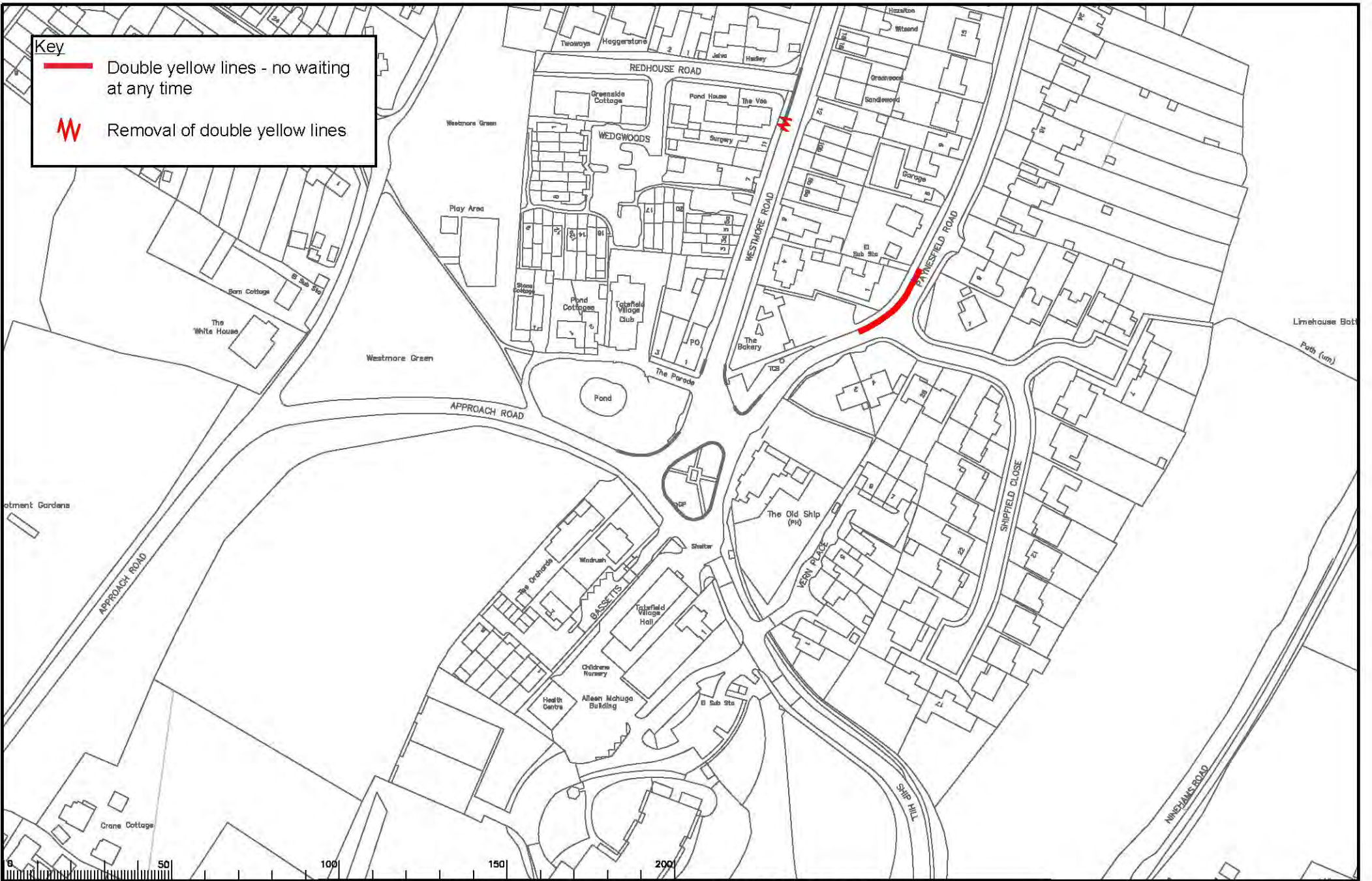

**Drawing number:
32**



Tatsfield - Painesfield Road and Westmore Road

**Drawing number:
33**

Key

-  Double yellow lines - no waiting at any time
-  Removal of double yellow lines (change to traffic order only - no change on the ground)

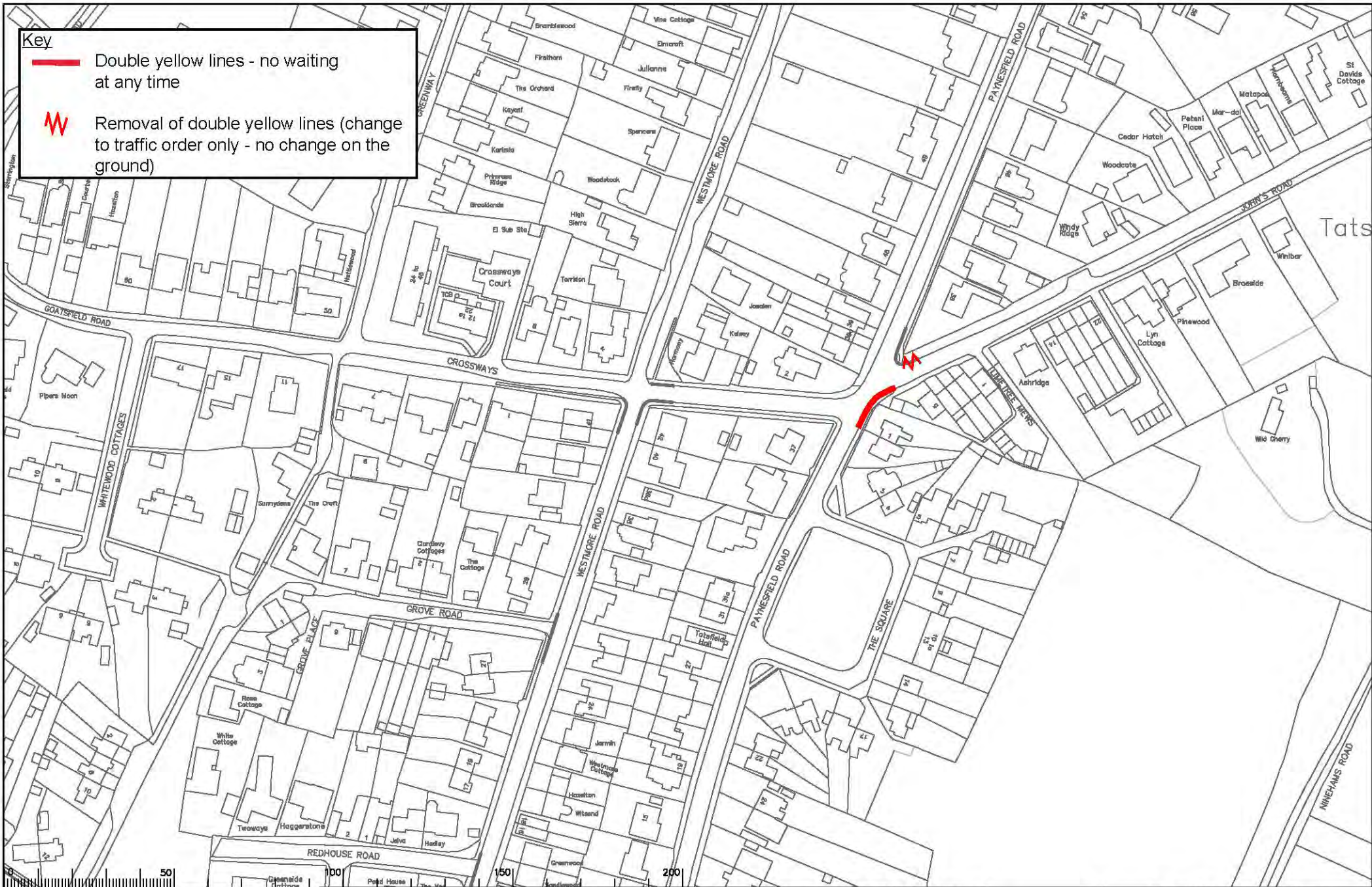

Tatsfield - Pynesfield Road, junction with John's Road

**Drawing number:
34**

Key

— Double yellow lines - no waiting at any time

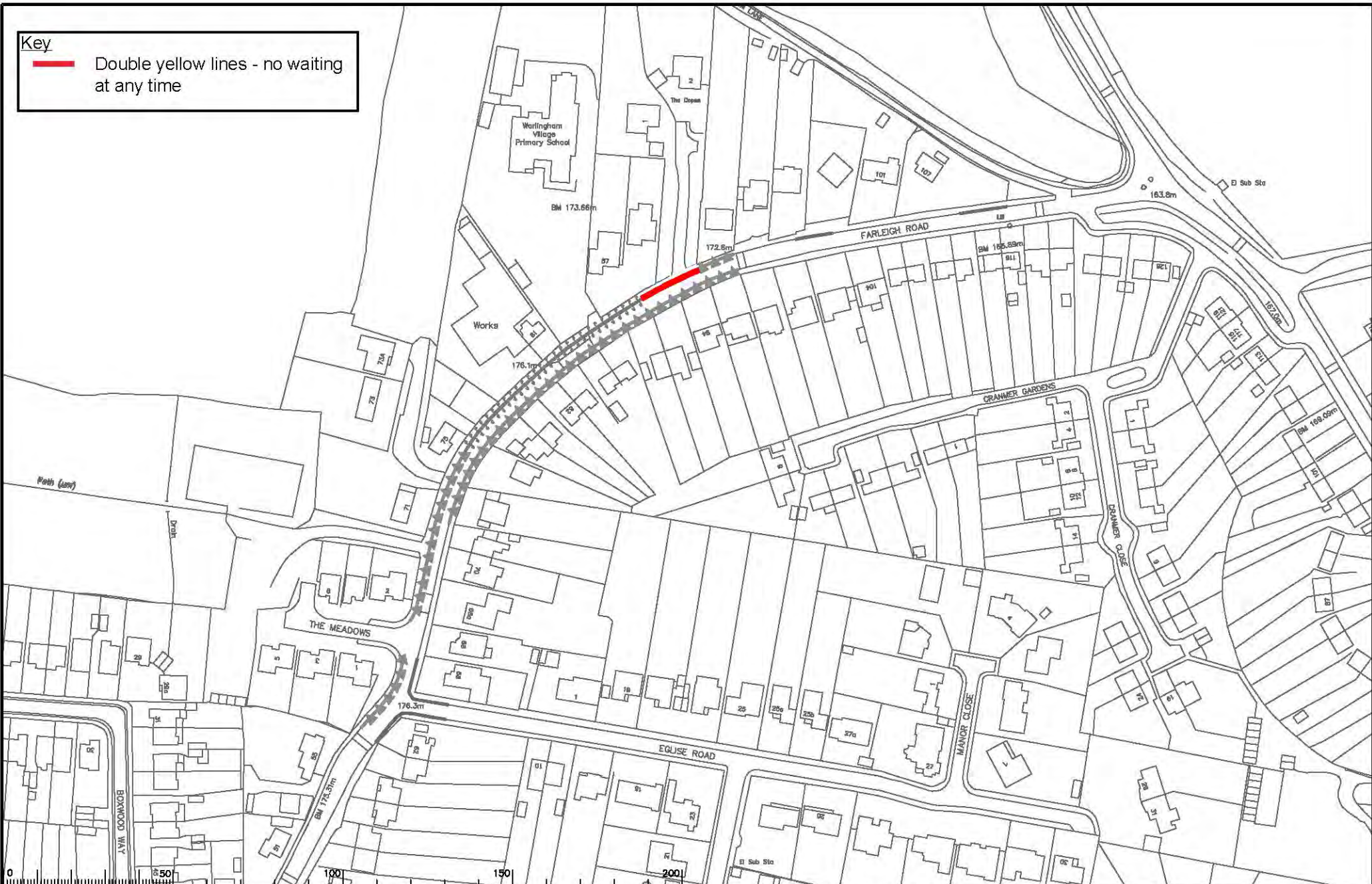

Warlingham - Farleigh Road, junction with The Copse

Drawing number:
35

Key
— Double yellow lines - no waiting at any time

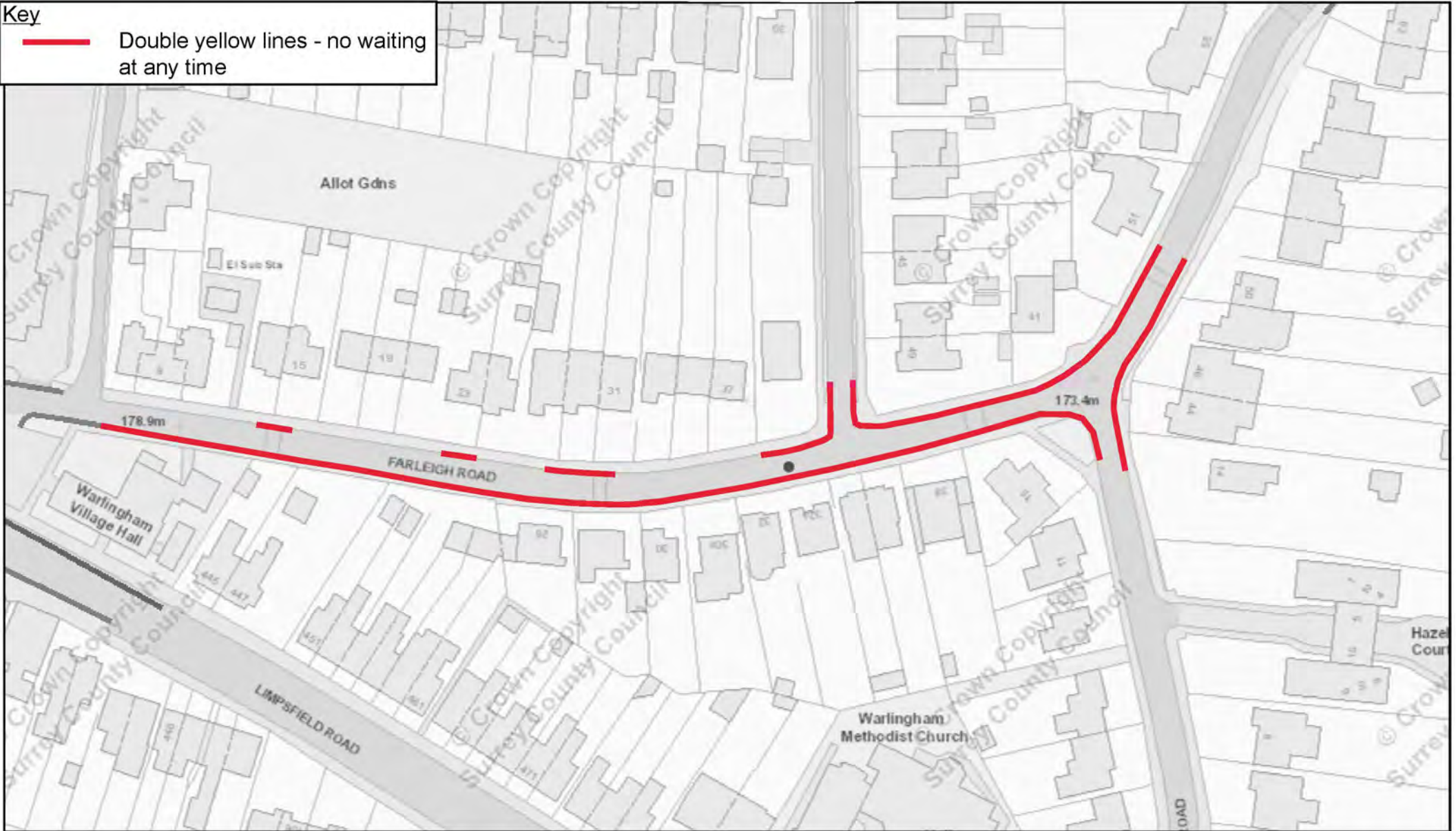

Warringham - Farleigh Road, including junctions with Boxwood Way and Bond Road

**Drawing number:
36**

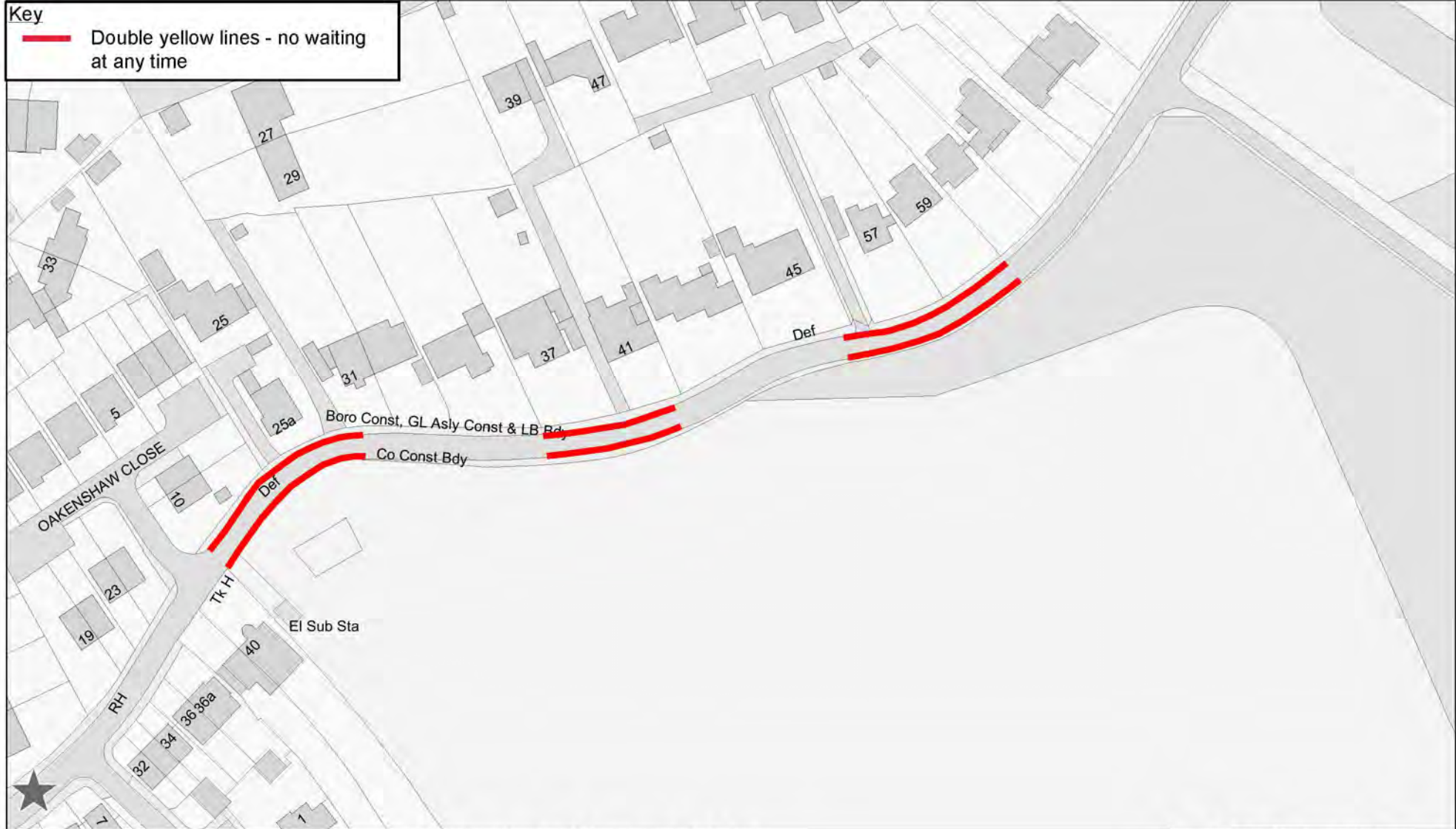

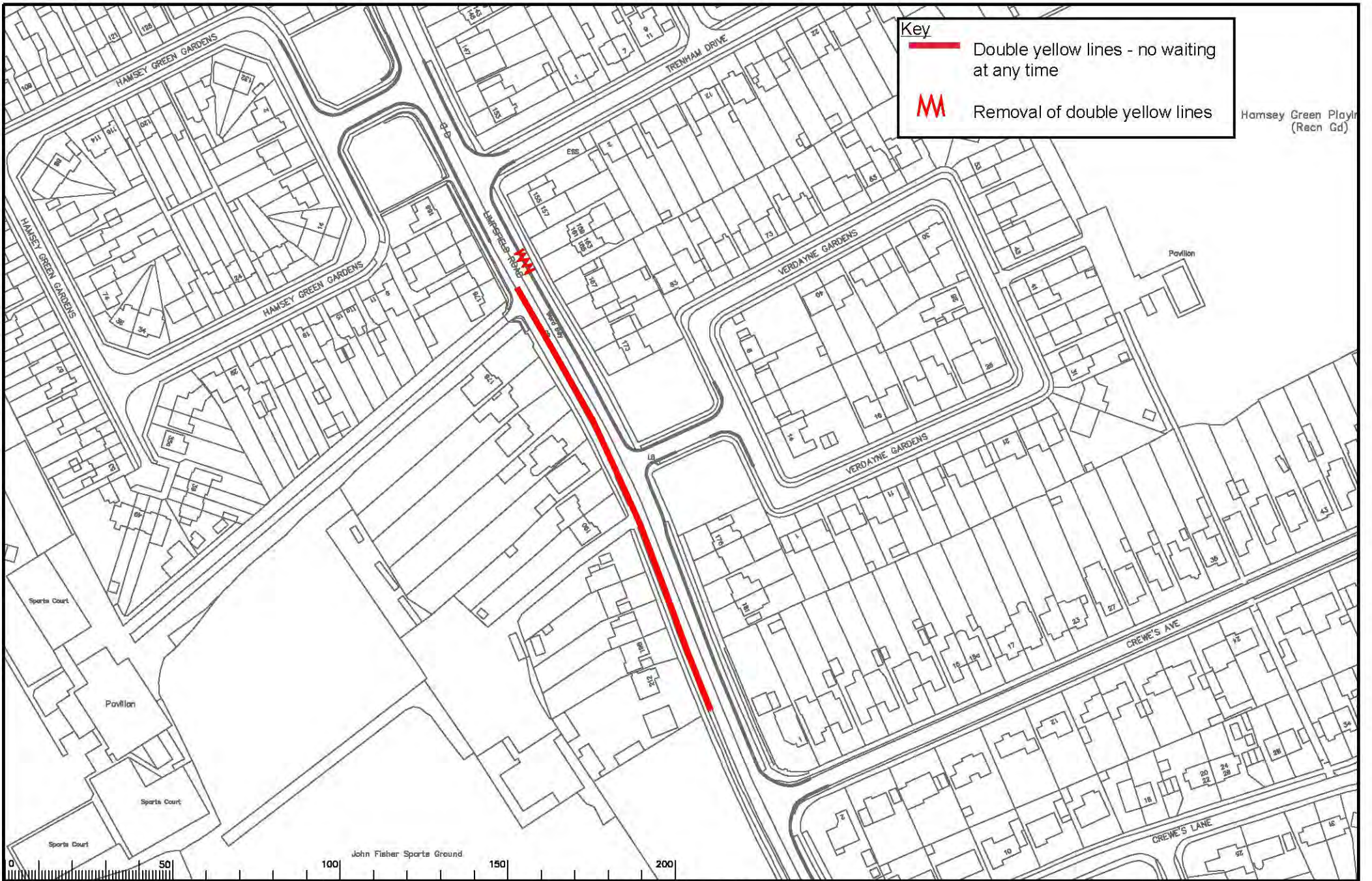

Warlingham - Kingswood Lane

**Drawing number:
37**



Key

-  Double yellow lines - no waiting at any time
-  Removal of double yellow lines

Hamsey Green Playr
(Recn Gd)

Warringham - Limpsfield Road

**Drawing number:
38**

Key

 Double yellow lines - no waiting at any time

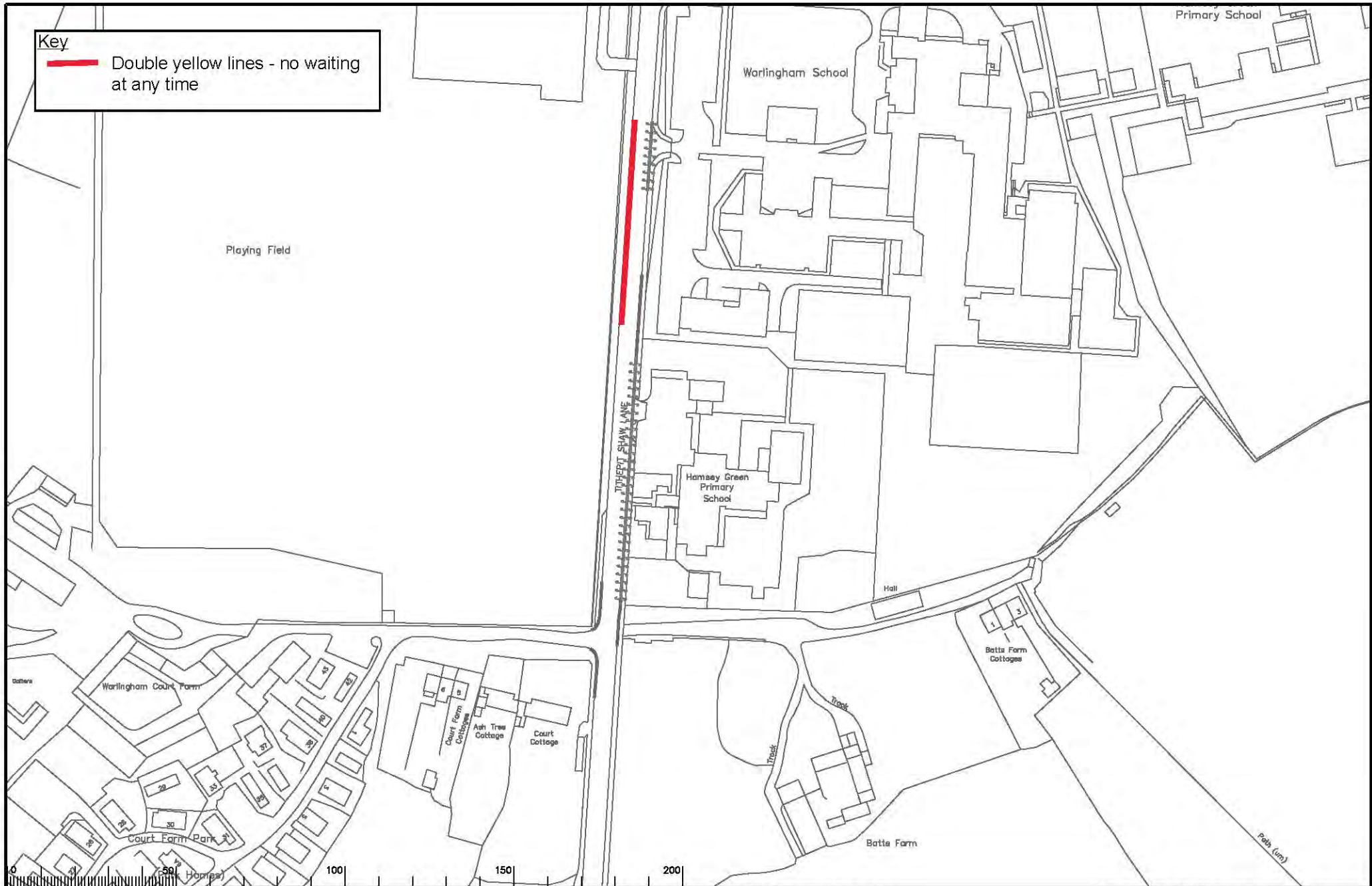

Warlingham - Tithepit Shaw Lane

Drawing number:
39

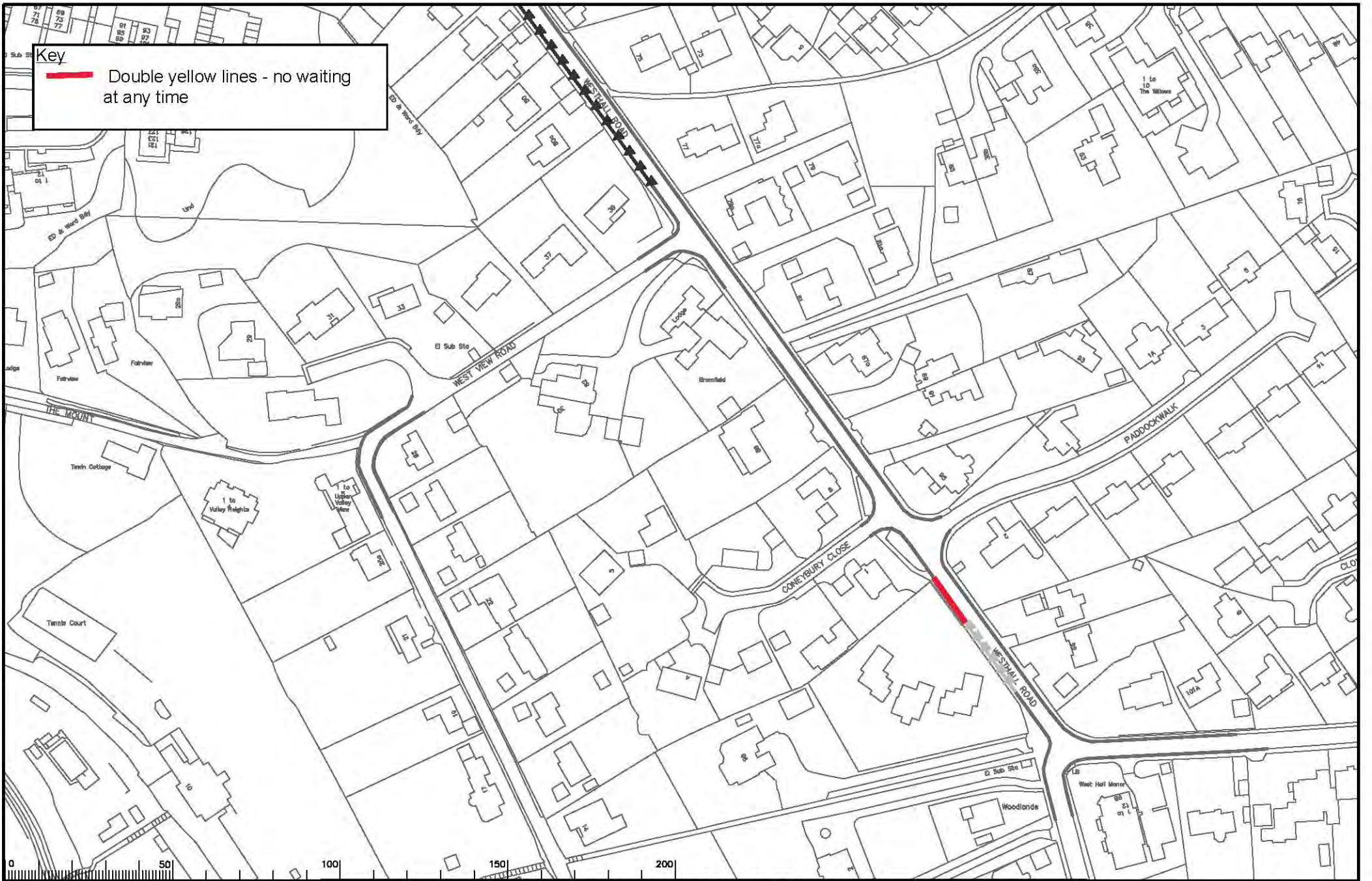

Key
 — Double yellow lines - no waiting at any time

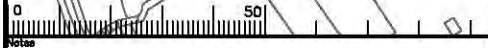

Warlingham - Westhall Road

Drawing number:
40