

KEY:

- TAKE UP EXISTING KERB LINE AND REMOVE TO TIP OFF SITE. LENGTH 16m
- EXISTING ROAD MARKINGS TO BE REMOVED
- EXISTING ILLUMINATED TRAFFIC BOLLARD TO BE REMOVED
- EXISTING TRAFFIC SIGN TO BE REMOVED TO TIP OFF SITE
- INSTALL NEW KERB LINE. LENGTH: 20m
- PROPOSED ROAD MARKINGS TO BE INSTALLED IN ACCORDANCE WITH T.S.R.G.D. 2016
- INSTALL NEW DROPPED KERBS INCLUDING RAKER KERBS
- SP2 INSTALL NEW SP2 KERBS
- NEW FOOTWAY CONSTRUCTION OVER EXISTING CARRIAGEWAY. AREA: 23.5m²
- INSTALL NEW TRAFFIC SIGN
- INSTALL NEW 'MALLATITE DURAFLEX' TRAFFIC BOLLARD
- INSTALL NEW TACTILE PAVING
- RESURFACE & BINDER EXISTING FOOTWAY. AREA: 24.5m²
- EXISTING ROAD MARKINGS TO REMAIN
- EXISTING TRAFFIC SIGN TO REMAIN
- PROPOSED HIGH FRICTION SURFACING. AREA: 650m²

Notes

Rev.	Description	Drwn	Sig.	Date	Chkd	Sig.	Date	Appr	Sig.	Date

North Point

Based upon the Ordnance Survey mapping with the permission of the Controller of Her Majesty's Stationary Office © Crown copyright. Unauthorised reproduction infringes Crown copyright and may lead to prosecution or civil proceedings. Surrey County Council LA 078872 2002.

Drawn by TC Sig. TC Date AUG 17

Checked by originator SP Sig. SP Date AUG 17

Approved by JD Sig. JD Date AUG 17

Project A217 REIGATE TO HORLEY (WHOLE ROUTE STUDY) SITE No. 12 - A217 HOOKWOOD RBT TO LONGBRIDGE RBT

Drawing SITE CLEARANCE & GENERAL ARRANGEMENT

SHEET 1 OF 2

Project No. SP0028

Contract Sheet No. 12-001

Rev. -

Classification DRAFT

SURREY COUNTY COUNCIL
Surrey Highway Transport Survey

Scale 1:200

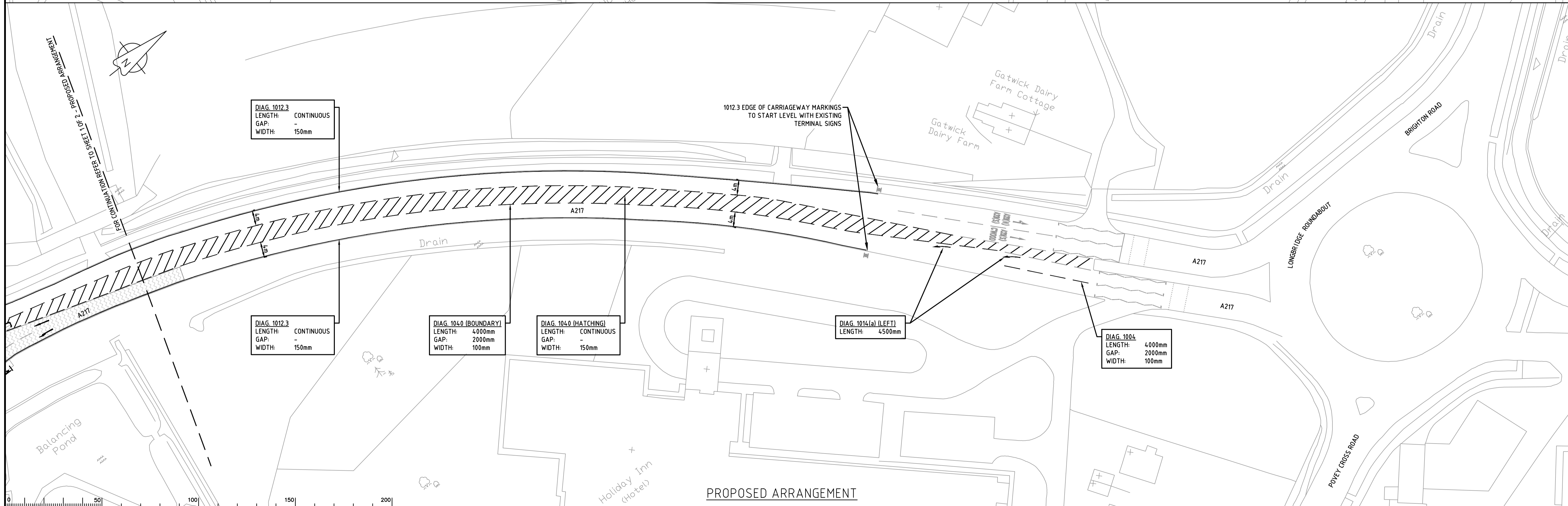
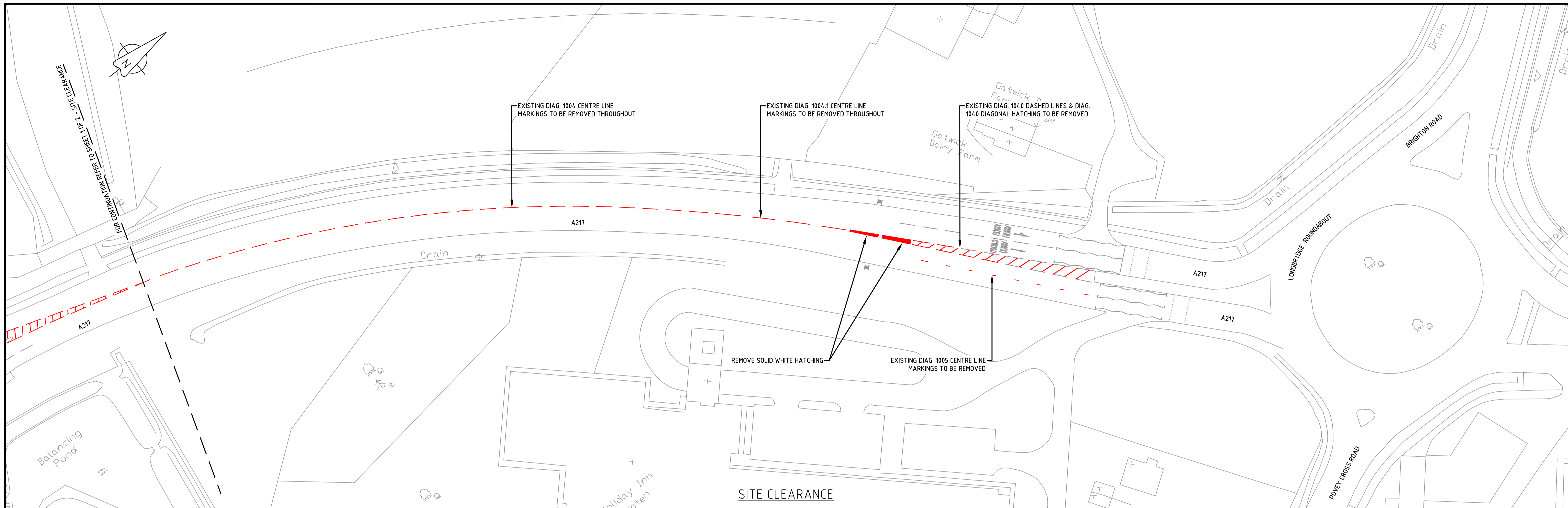

Notes

KEY:

- EXISTING ROAD MARKINGS TO BE REMOVED
- PROPOSED ROAD MARKINGS TO BE INSTALLED IN ACCORDANCE WITH T.S.R.G.D. 2016
- EXISTING ROAD MARKINGS TO REMAIN
- EXISTING TRAFFIC SIGN TO REMAIN

Rev.	Description	Drwn	Sig.	Date	Chkd	Sig.	Date	Appr	Sig.	Date

North Point

Scale 1:500

Based upon the Ordnance Survey mapping with the permission of the Controller of Her Majesty's Stationery Office © Crown copyright. Unauthorised reproduction infringes Crown copyright and may lead to prosecution or civil proceedings. Surrey County Council LA 078872 2002.

Drawn by	TC	Sig.	SP	Date	AUG 17
Checked by originator	SP	Sig.	SP	Date	AUG 17
Approved by	JD	Sig.	JD	Date	AUG 17

Project A217 REIGATE TO HORLEY (WHOLE ROUTE STUDY)
 SITE No. 12 - A217 HOOKWOOD RBT TO LONGBRIDGE RBT

Drawing

SITE CLEARANCE & GENERAL ARRANGEMENT

SHEET 2 OF 2

Project No. SP0028

Contract Sheet No. 12-002

Rev. -

Classification DRAFT

SURREY COUNTY COUNCIL
 Surrey Highway Transport for Surrey