



KEY	
	PROPOSED NO WAITING AT ANY TIME
	PROPOSED DISABLED PARKING BAY BLUE BADGE HOLDERS ONLY AT ANY TIME NO TIME LIMIT
	EXISTING WAITING, LOADING AND PARKING RESTRICTIONS (WITH OR WITHOUT SYMBOLS)
	REVOCATION OF EXISTING WAITING, LOADING AND PARKING RESTRICTIONS (NOT VISIBLE IF UNDER PROPOSALS)

AMENDMENT FOR TRAFFIC REGULATION ORDER PLANS ONLY TO MATCH CURRENT LAYOUT ON GROUND

Rev.	Description	Drawn	Sig.	Date	Chkd	Sig.	Date	Appr.	Sig.	Date

Notes										

North Point										

<p>Notes about the Ordnance Survey mapping with the permission of the Controller of Her Majesty's Stationery Office. Crown copyright. Unauthorised reproduction without Crown copyright may lead to prosecution if it is proved.</p> <p>© Crown Copyright. All Rights Reserved.</p>		<p>Project: SPELTHORNE DPE</p> <p>Drawing No: 2024-02</p> <p>Revision: </p>	<p>Project No: 3282/SPEL</p> <p>Client: SURREY</p> <p>Contract: </p> <p>Drawn by: </p> <p>Checked by: </p> <p>Approved by: </p> <p>Date: </p>	<p>Project: SPELTHORNE DPE</p> <p>Drawing No: 2024-02</p> <p>Revision: </p> <p>Client: SURREY</p> <p>Contract: </p> <p>Drawn by: </p> <p>Checked by: </p> <p>Approved by: </p> <p>Date: </p>
---	--	---	---	---

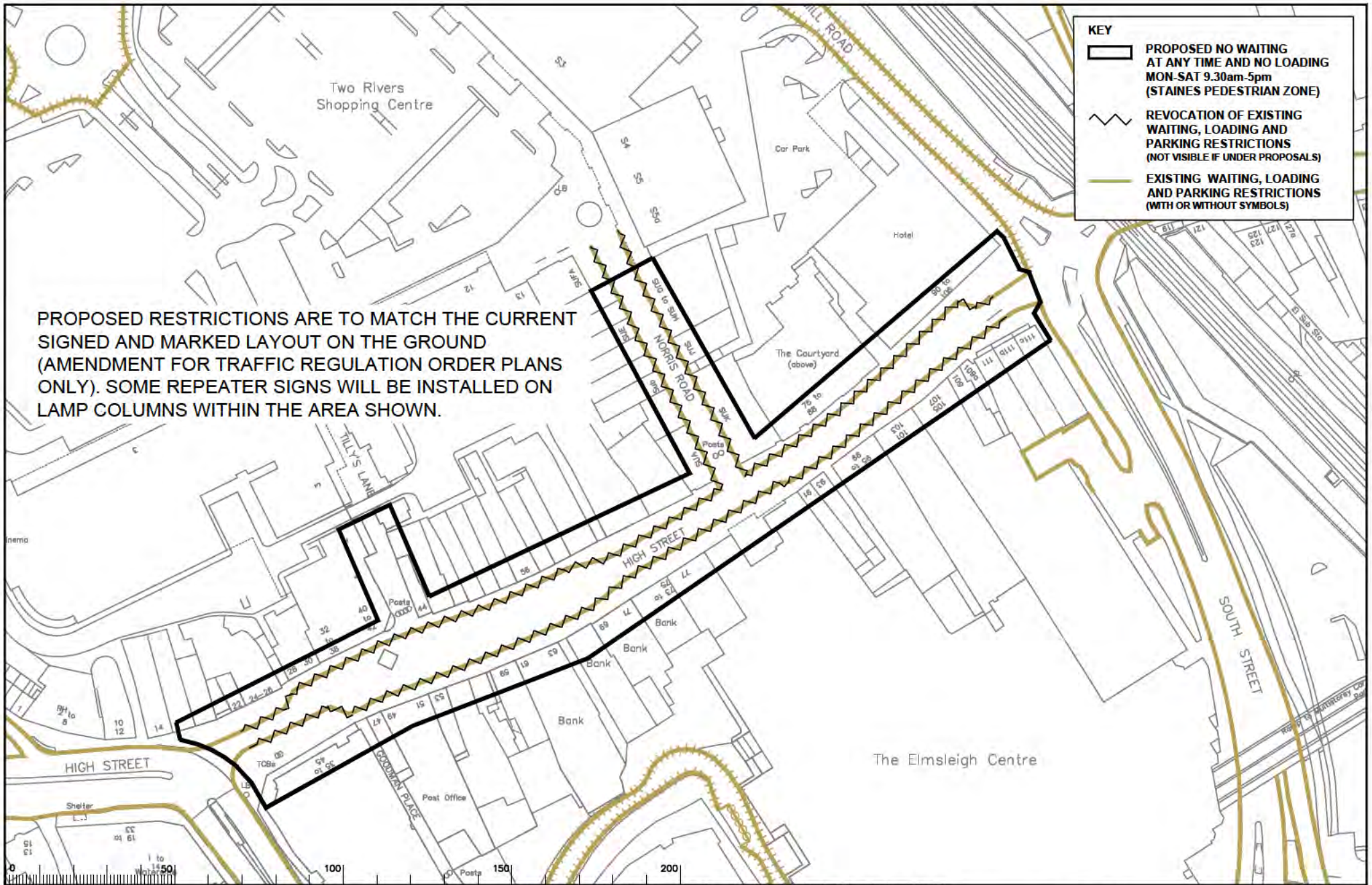

KEY

- PROPOSED NO WAITING AT ANY TIME AND NO LOADING AT ANY TIME AND NO LOADING MON-SAT 9.30am-5pm (STAINES PEDESTRIAN ZONE)**
- REVOCAION OF EXISTING WAITING, LOADING AND PARKING RESTRICTIONS (NOT VISIBLE IF UNDER PROPOSALS)**
- EXISTING WAITING, LOADING AND PARKING RESTRICTIONS (WITH OR WITHOUT SYMBOLS)**

PROPOSED RESTRICTIONS ARE TO MATCH THE CURRENT SIGNED AND MARKED LAYOUT ON THE GROUND (AMENDMENT FOR TRAFFIC REGULATION ORDER PLANS ONLY). SOME REPEATER SIGNS WILL BE INSTALLED ON LAMP COLUMNS WITHIN THE AREA SHOWN.

Notes

Rev.	Description	Drawn	Sig.	Date	Chkd	Sig.	Date	Appr.	Sig.	Date

Rev.	Description	Drawn	Sig.	Date	Chkd	Sig.	Date	Appr.	Sig.	Date

North Point

These plans are the product of a survey carried out by the contractor of the Director of the Highway Authority of the County of Surrey. The contractor is responsible for the accuracy of the information contained in these plans and the user may be held responsible for any errors or omissions. The County Council is not liable for any errors or omissions.

Project: **SPELTHORNE DPE**

Implemented Traffic Orders

Project No. **3282/SPEL**

SURREY
Surrey County Council
Surrey
2024-03

ADVERTISED

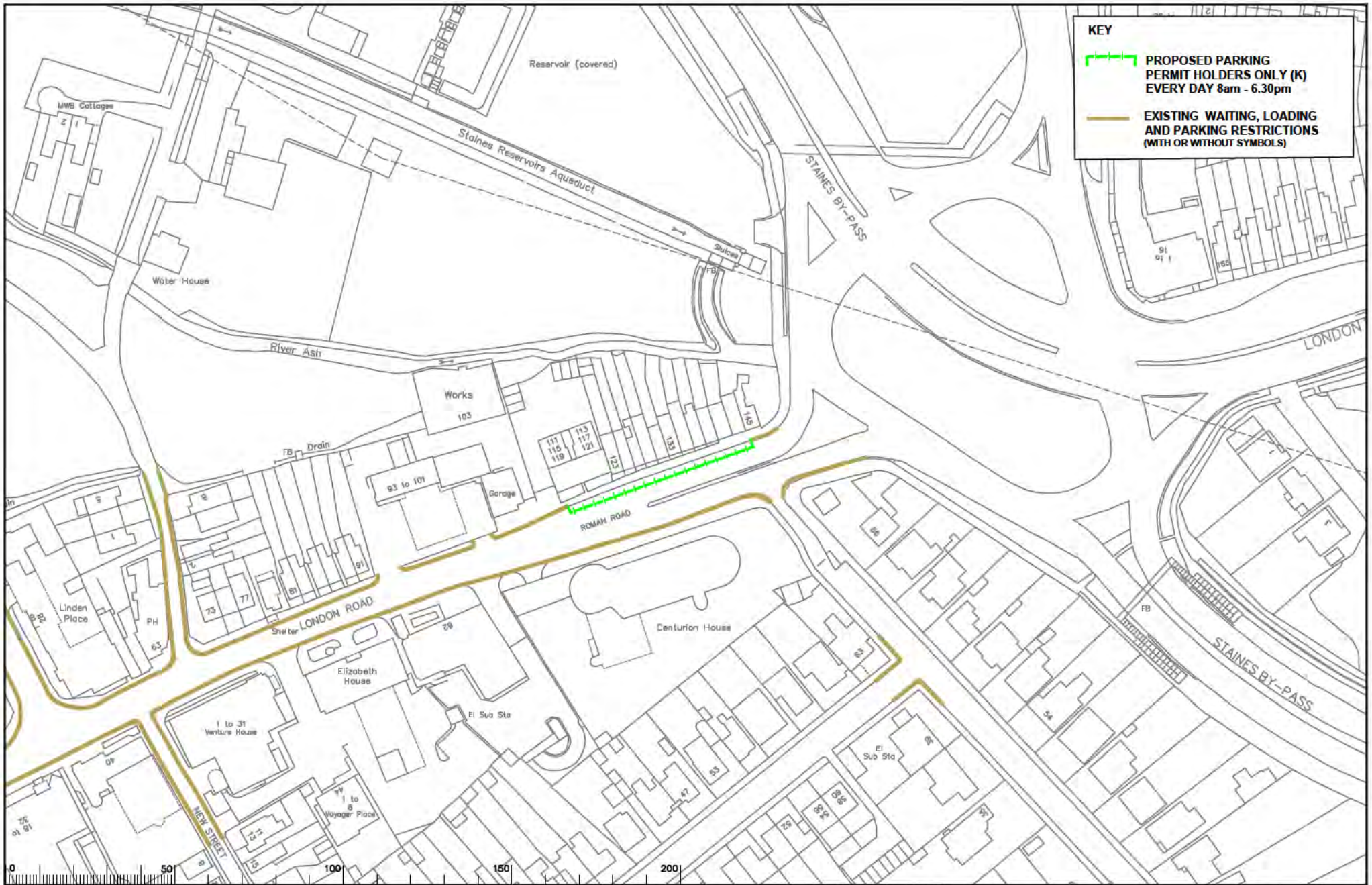

KEY

- PROPOSED PARKING PERMIT HOLDERS ONLY (K) EVERY DAY 8am - 6.30pm
- EXISTING WAITING, LOADING AND PARKING RESTRICTIONS (WITH OR WITHOUT SYMBOLS)



Notes

Rev.	Description	Drawn	Sig.	Date	Checked	Sig.	Date	Approved	Sig.	Date

Rev.	Description	Drawn	Sig.	Date	Checked	Sig.	Date	Approved	Sig.	Date

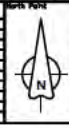

Notes upon the issuance of this drawing are the responsibility of the Contractor. It is the Contractor's responsibility to ensure that all information is correct and up to date. The Contractor shall be responsible for any errors or omissions on this drawing.

Checked by: JH Date: 2024-04-04
 Approved by: DC Date: 2024-04-04

Project: **SPELTHORNE DPE**

Drawn: **Implemented Traffic Orders**

Project No: 3282/SPEL
 Drawing No: 2024-04
 Date: 2024-04
 Status: **ADVERTISED**

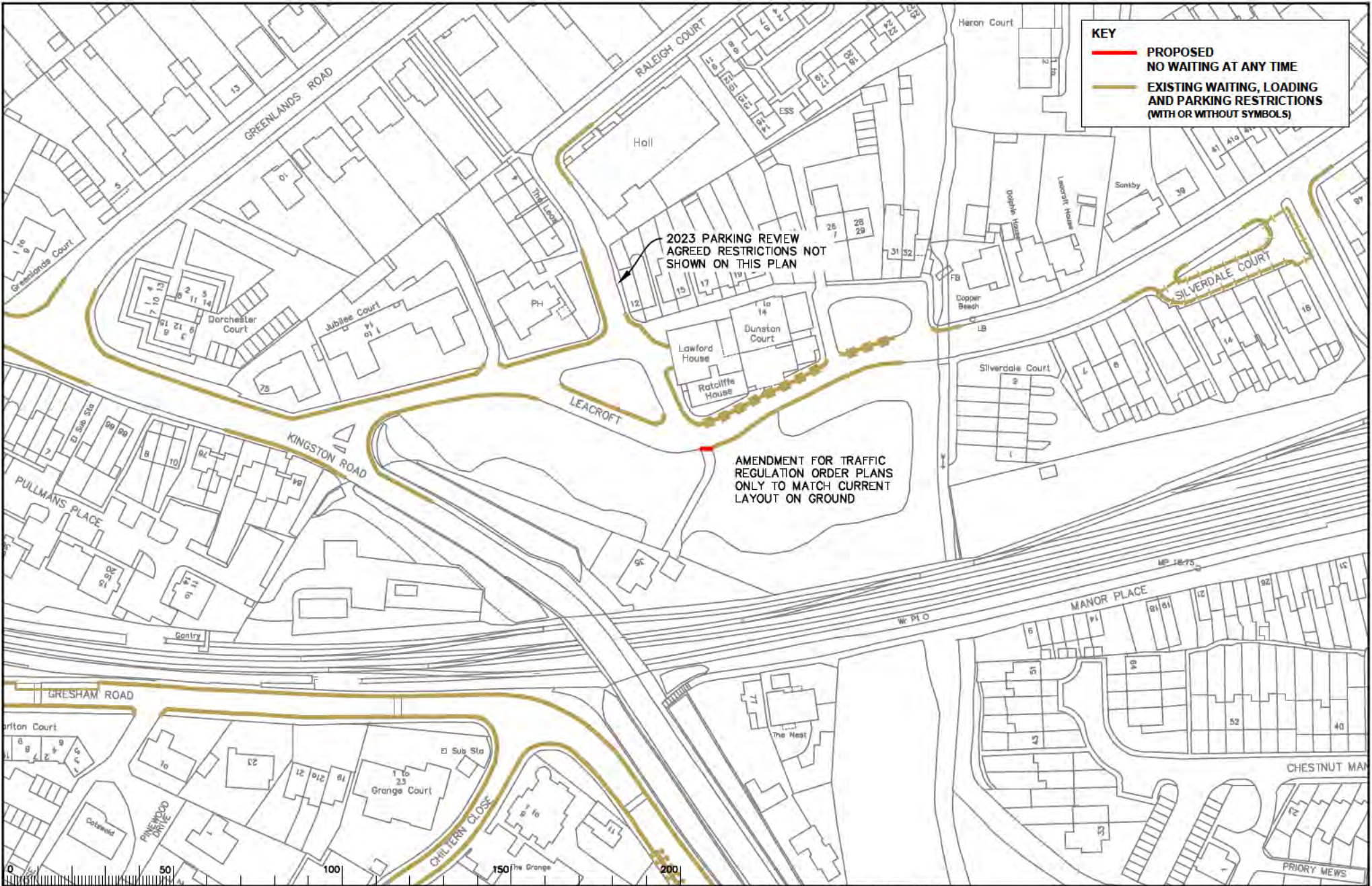

KEY

— PROPOSED
NO WAITING AT ANY TIME

— EXISTING WAITING, LOADING
AND PARKING RESTRICTIONS
(WITH OR WITHOUT SYMBOLS)

2023 PARKING REVIEW
AGREED RESTRICTIONS NOT
SHOWN ON THIS PLAN

AMENDMENT FOR TRAFFIC
REGULATION ORDER PLANS
ONLY TO MATCH CURRENT
LAYOUT ON GROUND

Notes

Rev.	Description	Drawn	Sig.	Date	Checkd	Sig.	Date	Appr.	Sig.	Date



Notes about the Ordnance Survey mapping are the
property of the Ordnance Survey and are not to be
reproduced without their permission. The Ordnance
Survey is not responsible for any errors or omissions
which may appear hereon.

Project:

SPELTHORNE DPE

Implemented Traffic Orders

Project No: 3282/SPEL

Drawing No: 2024-05

Classification: ADVERTISED

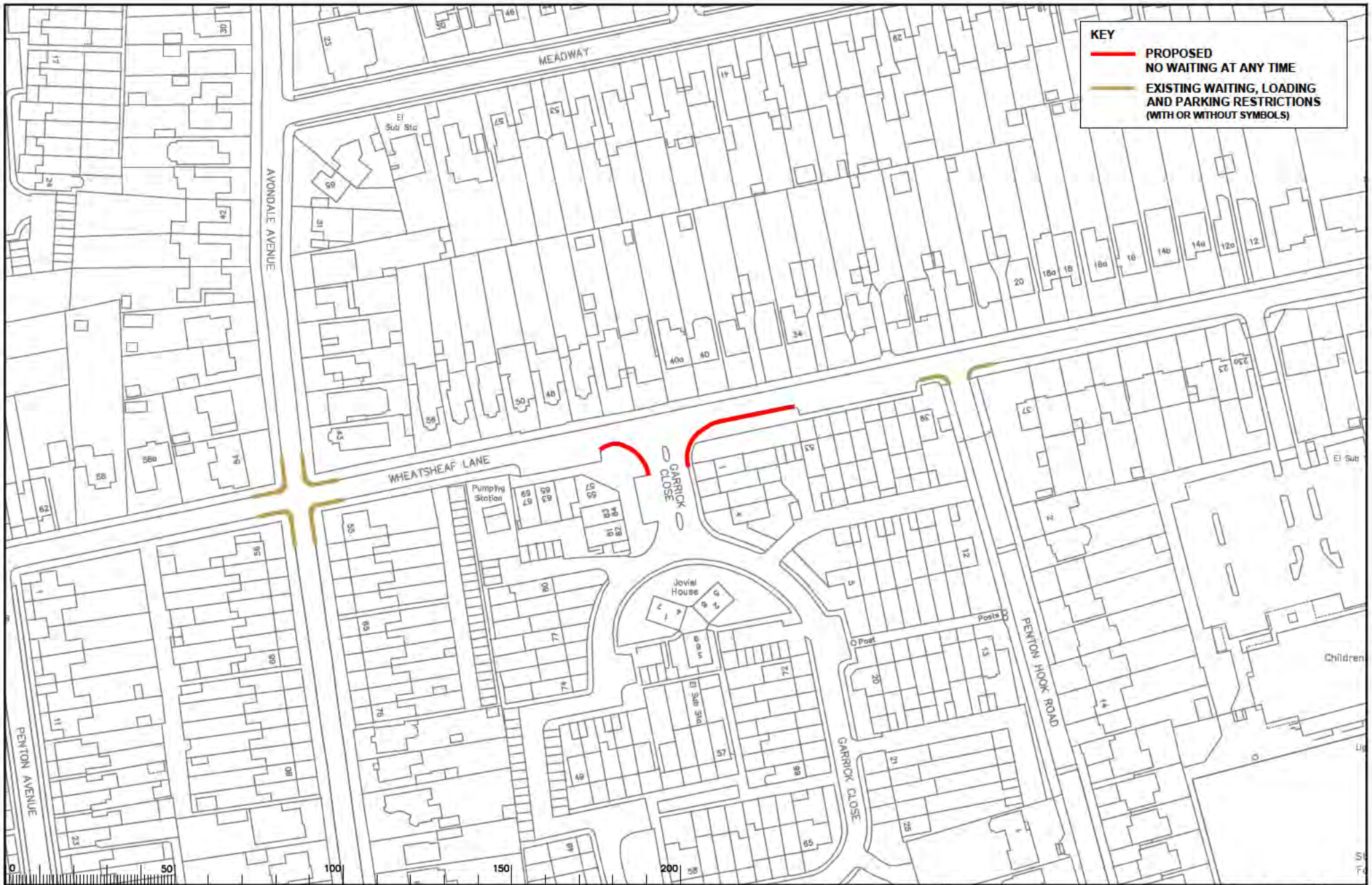

KEY

- PROPOSED
NO WAITING AT ANY TIME
- EXISTING WAITING, LOADING
AND PARKING RESTRICTIONS
(WITH OR WITHOUT SYMBOLS)

Notes

Rev.	Description	Drawn	Sig.	Date	Check	Sig.	Date	Appr.	Sig.	Date

Rev.	Description	Drawn	Sig.	Date	Check	Sig.	Date	Appr.	Sig.	Date

North Point

These signs are the minimum signs required for the implementation of the proposed traffic order. The sign designer should refer to the Traffic Signs Manual for further details on sign design and placement. The sign designer should refer to the Traffic Signs Manual for further details on sign design and placement.

Drawn by	Checked by	Approved by	Date
JH	JH	JH	2024
DC	DC	DC	2024

Project: **SPELTHORNE DPE**

Implemented Traffic Orders

Scale: 1:1000

SURREY
County Council
Surrey

Project No: 3282/SPEL

Drawing No: 2024-06

Scale: 1:1000

Author: [Name]

Checked: [Name]

Approved: [Name]

Date: 2024

ADVERTISED