



KEY

- PROPOSED NO WAITING AT ANY TIME
- REVOKE EXISTING RESTRICTION
- - - EXISTING WAITING, LOADING AND PARKING RESTRICTIONS (WITH OR WITHOUT SYMBOLS)

Notes

Rev	Description	Drwn	Sig.	Date	Chkd	Sig.	Date	Appr	Sig.	Date
A	RESTRICTIONS AMENDED	CAH	CAH	07.16	AH	AH	07.16	RH	RH	07.16
B	RESTRICTIONS AMENDED	CAH	CAH	10.19	AH	AH	10.19	DC	DC	10.19
C	RESTRICTIONS AMENDED	SDC	SDC	10.21	RH	RH	10.21	DC	DC	10.21
D	RESTRICTIONS AMENDED	RB	RB	06.22	AC	AC	06.22	RH	RH	06.22

North Point

Based upon the Ordnance Survey mapping with the permission of the Controller of Her Majesty's Stationery Office. © Crown copyright. Unauthorised reproduction infringes Crown copyright and may lead to prosecution or civil proceedings. Surrey County Council LA 070822 1006.

Drawn by	CAH	Sig.	CAH	Date	2012
Checked by	RH	Sig.	RH	Date	2012
Approved by	DC	Sig.	DC	Date	2012

Project: REIGATE AND BANSTEAD DPE HORLEY

Drawing: IMPLEMENTED TRAFFIC ORDERS

SHEET OF

SURREY COUNTY COUNCIL

Project No. 3282/R&B

Contract Sheet No. 18108

Rev. D

Classification: PROPOSAL

Scale 1:1250

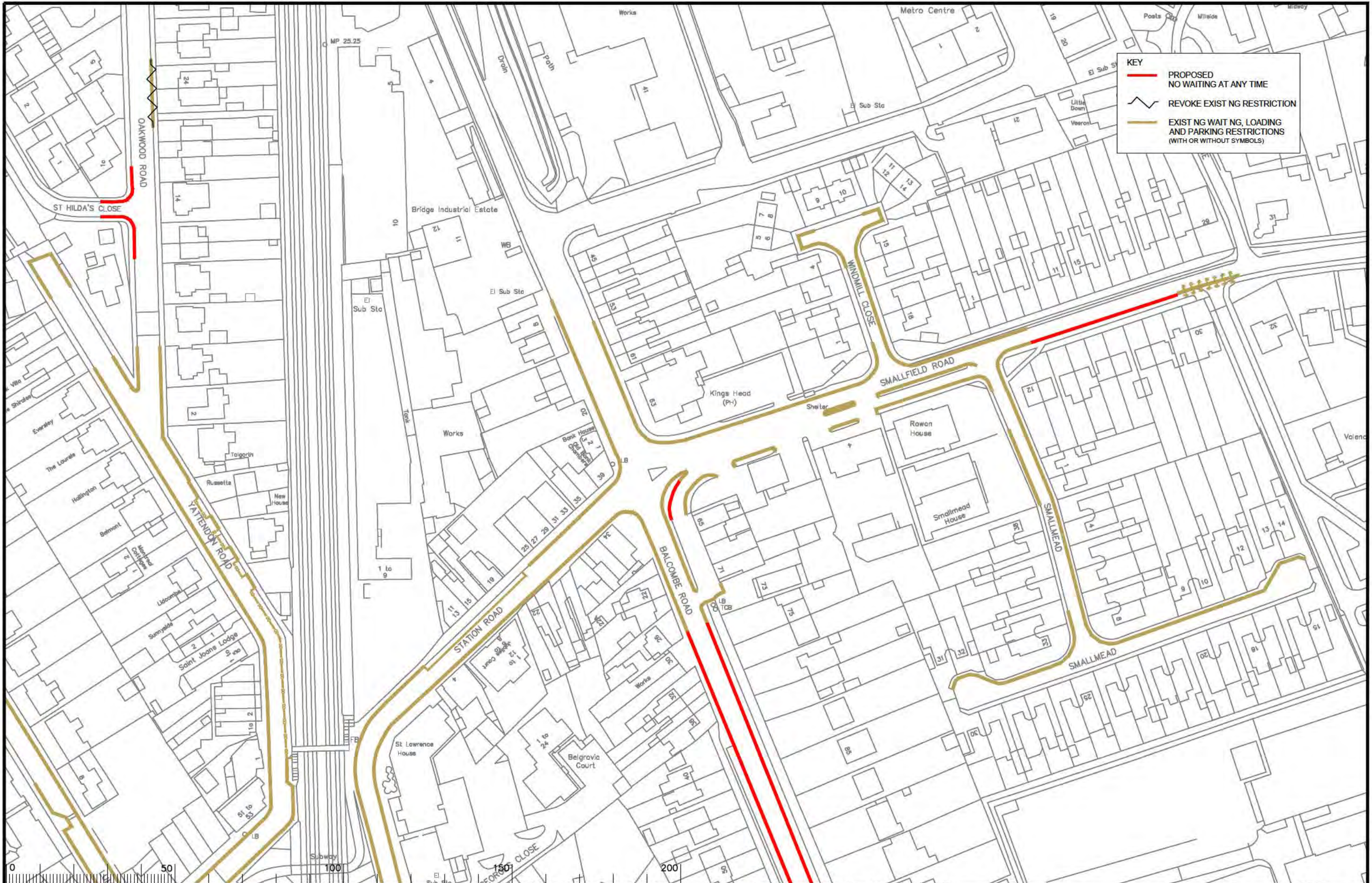

KEY

- PROPOSED NO WAITING AT ANY TIME
- ~ REVOKE EXISTING RESTRICTION
- EXISTING WAITING, LOADING AND PARKING RESTRICTIONS (WITH OR WITHOUT SYMBOLS)

Notes

Rev.	Description	Drwn	Sig.	Date	Chkd	Sig.	Date	Appr	Sig.	Date
A	RESTRICTIONS AMENDED	CAH	CAH	07.16	AH	AH	07.16	RH	RH	07.16
B	RESTRICTIONS AMENDED	CAH	CAH	01.19	RH	RH	10.21	DC	DC	01.19
C	RESTRICTIONS AMENDED	SJC	SJC	10.21	RH	RH	10.21	DC	DC	10.21
D	RESTRICTIONS AMENDED	RB	RB	06.22	AC	AC	06.22	RH	RH	06.22

Rev.	Description	Drwn	Sig.	Date	Chkd	Sig.	Date	Appr	Sig.	Date
A	RESTRICTIONS AMENDED	CAH	CAH	07.16	AH	AH	07.16	RH	RH	07.16
B	RESTRICTIONS AMENDED	CAH	CAH	01.19	RH	RH	10.21	DC	DC	01.19
C	RESTRICTIONS AMENDED	SJC	SJC	10.21	RH	RH	10.21	DC	DC	10.21
D	RESTRICTIONS AMENDED	RB	RB	06.22	AC	AC	06.22	RH	RH	06.22

Scale 1:1250

North Point

Based upon the Ordnance Survey mapping with the permission of the Controller of Her Majesty's Stationery Office. © Crown copyright. Unauthorised reproduction infringes Crown copyright and may lead to prosecution or civil proceedings. Surrey County Council LA 02872 1996.

Drawn by: CAH, Sig. CAH, Date 2012
 Checked by: RH, Sig. RH, Date 2012
 Approved by: DC, Sig. DC, Date 2012

Project: REIGATE AND BANSTEAD DPE HORLEY

Drawing: IMPLEMENTED TRAFFIC ORDERS

SHEET OF

Project No. 3282/R&B
 Contract Sheet No. 18111
 Rev. D
 Classification: PROPOSAL

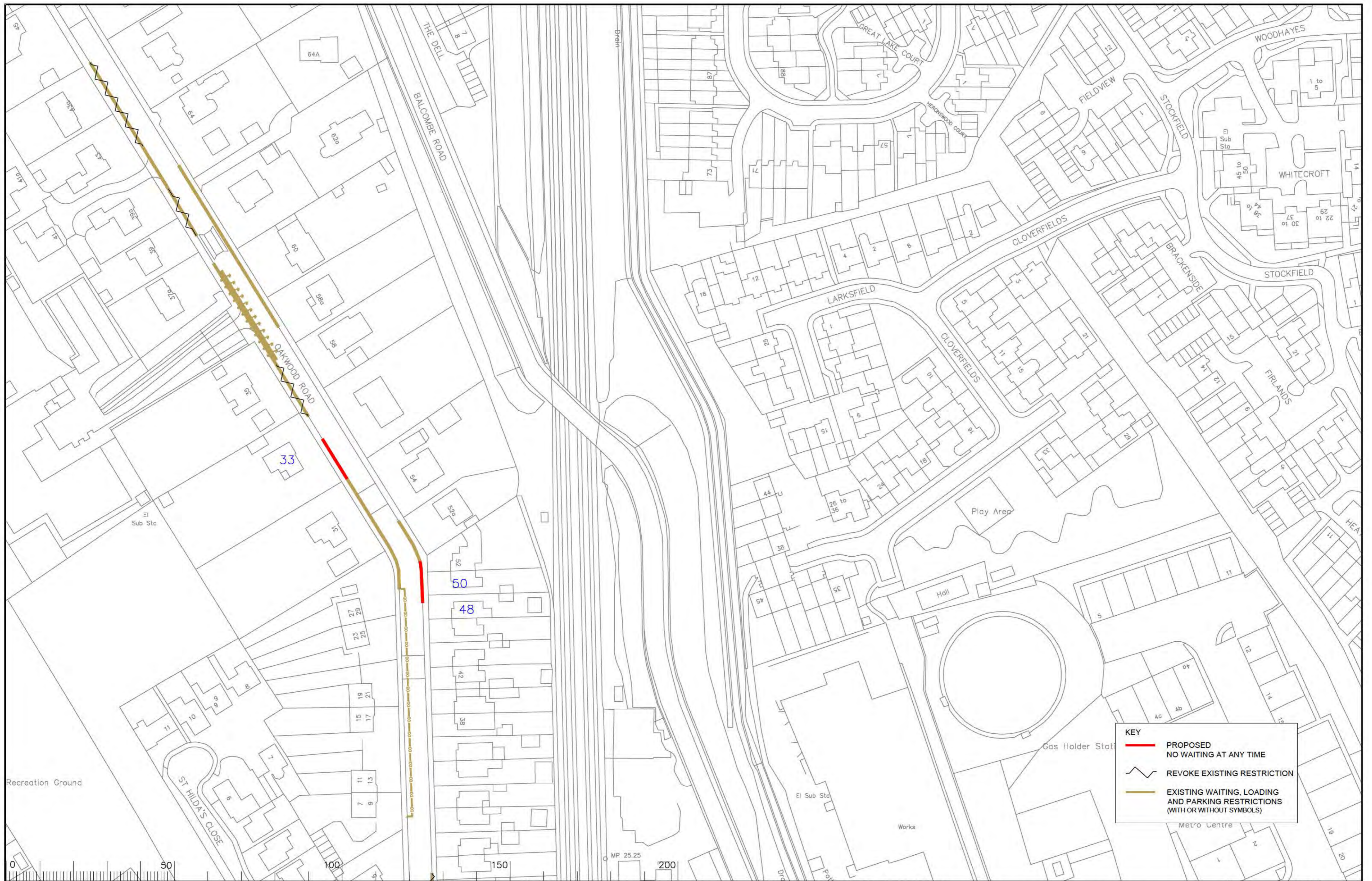

KEY

- PROPOSED NO WAITING AT ANY TIME
- REVOKE EXISTING RESTRICTION
- EXISTING WAITING, LOADING AND PARKING RESTRICTIONS (WITH OR WITHOUT SYMBOLS)

Notes

Rev.	Description	Drwn	Sig.	Date	Chkd	Sig.	Date	Appr	Sig.	Date
A	RESTRICTIONS AMENDED	SDC	SDC	10.21	RH	RH	10.21	DC	DC	10.21
B	RESTRICTIONS AMENDED	RB	RB	06.22	AC	AC	06.22	RH	RH	06.22

Rev.	Description	Drwn	Sig.	Date	Chkd	Sig.	Date	Appr	Sig.	Date
A	RESTRICTIONS AMENDED	SDC	SDC	10.21	RH	RH	10.21	DC	DC	10.21
B	RESTRICTIONS AMENDED	RB	RB	06.22	AC	AC	06.22	RH	RH	06.22

Scale 1:1250

North Point

Based upon the Ordnance Survey mapping with the permission of the Controller of Her Majesty's Stationery Office. Crown copyright. Unauthorised reproduction infringes Crown copyright and may lead to prosecution or civil proceedings. Surrey County Council LA 076872 1996.

Drawn by	CAH	Sig.	CAH	Date	07.16
Checked by originator	AH	Sig.	AH	Date	07.16
Approved by	RH	Sig.	RH	Date	07.16

Project

REIGATE AND BANSTEAD DPE
HORLEY

Drawing

IMPLEMENTED TRAFFIC ORDERS

SHEET OF

Project No. 3282/R&B

Contract Sheet No.

Drawing No. 18185

Rev. B

Classification PROPOSAL