

**KEY**

- PROPOSED NO WAITING AT ANY TIME
- - - PROPOSED PARKING MONDAY-SATURDAY 08.00-18.00 2hrs NO RETURN 2hrs
- EXISTING WAITING, LOADING AND PARKING RESTRICTIONS (WITH OR WITHOUT SYMBOLS)

Notes

Rev.	Description	Drwn	Sig.	Date	Chkd	Sig.	Date	Appr	Sig.	Date
A	RESTRICTIONS AMENDED	CAH	CAH	07.17	JAR	JAR	07.17	RH	RH	07.17
B	RESTRICTIONS AMENDED	CAH	CAH	10.19	PW	PW	10.19	DC	DC	10.19

North Point

Based upon the Ordnance Survey mapping with the permission of the Controller of Her Majesty's Stationery Office © Crown copyright. Unauthorised reproduction infringes Crown copyright and may lead to prosecution or civil proceedings. Surrey County Council LA 076872 1996.

Drawn by: CAH, Sig. CAH, Date 04.16  
 Checked by: JAR, Sig. JAR, Date 04.16  
 Approved by: RH, Sig. RH, Date 04.16

Project: RUNNYMEDE DPE  
 ENGLEFIELD GREEN DIVISION

Implemented Traffic Orders  
 ENGLEFIELD GREEN

SHEET OF

**SURREY COUNTY COUNCIL**

Project No. 3282/RUN  
 Contract Sheet No. 3282\_71  
 Drawing No. B  
 Rev. B  
 Classification: PROPOSAL

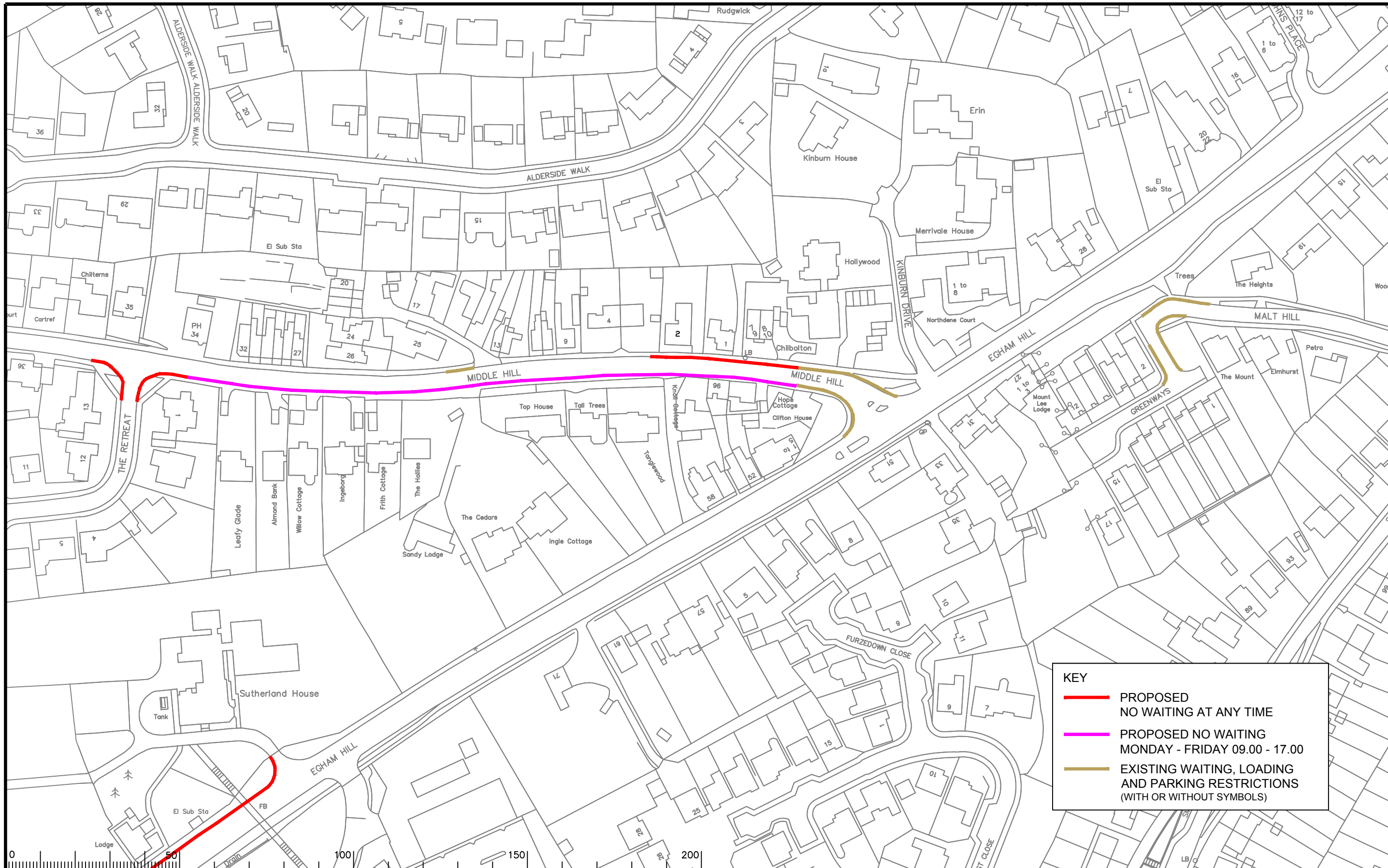

**KEY**

- PROPOSED NO WAITING AT ANY TIME
- PROPOSED NO WAITING MONDAY - FRIDAY 09.00 - 17.00
- EXISTING WAITING, LOADING AND PARKING RESTRICTIONS (WITH OR WITHOUT SYMBOLS)

Notes

Rev.	Description	Drwn	Sig.	Date	Chkd	Sig.	Date	Appr	Sig.	Date
A	RESTRICTIONS AMENDED	CAH	CAH	10.19	PW	PW	10.19	DC	DC	10.19

North Point

Scale 1:1250

Project

**RUNNYMEDE DPE**  
**ENGLEFIELD GREEN DIVISION**

**IMPLEMENTED TRAFFIC ORDERS**  
**ENGLEFIELD GREEN**

SHEET OF

Project No. 3282/RUN  
 Contract Sheet No. 3282\_83  
 Drawing No. 3282\_83  
 Rev. A  
 Classification: PROPOSAL

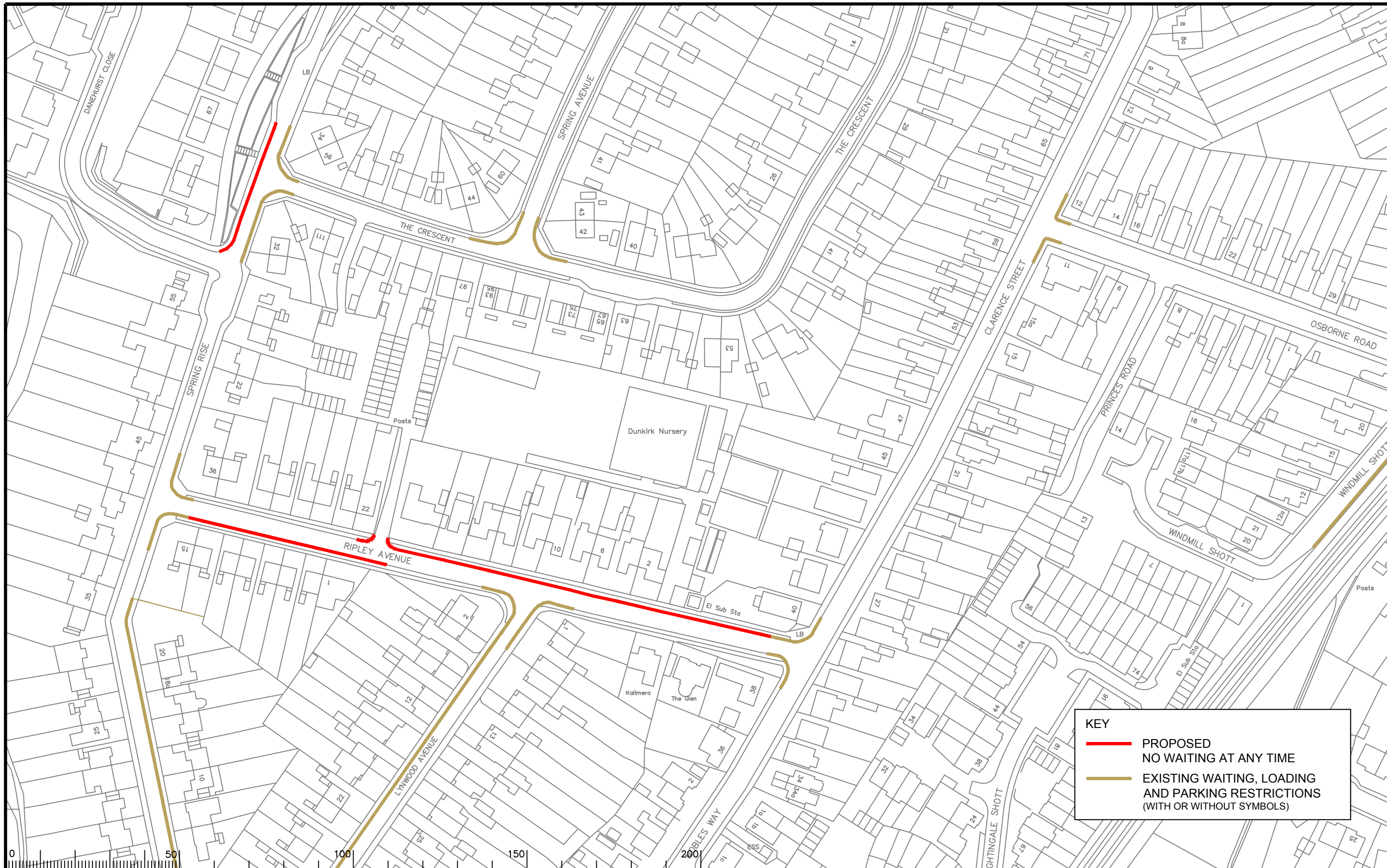

**KEY**

- PROPOSED NO WAITING AT ANY TIME
- EXISTING WAITING, LOADING AND PARKING RESTRICTIONS (WITH OR WITHOUT SYMBOLS)

Notes

Rev.	Description	Drwn	Sig.	Date	Chkd	Sig.	Date	Appr	Sig.	Date
A	RESTRICTIONS AMENDED	CAH	CAH	02.16	JAR	JAR	02.16	RH	RH	02.16
B	RESTRICTIONS AMENDED	CAH	CAH	07.17	JAR	JAR	07.17	RH	RH	07.17
C	RESTRICTIONS AMENDED	CAH	CAH	09.18	PW	PW	09.18	DC	DC	09.18
D	RESTRICTIONS AMENDED	CAH	CAH	10.19	PW	PW	10.19	DC	DC	10.19

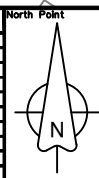

Based upon the Ordnance Survey mapping with the permission of the Controller of Her Majesty's Stationery Office. Crown copyright. Unauthorised reproduction infringes Crown copyright and may lead to prosecution or civil proceedings. Surrey County Council LA 076872 1996.

Drawn by: CAH Sig. CAH Date 07.14  
 Checked by: JAR Sig. JAR Date 07.14  
 Approved by: RH Sig. RH Date 07.14

Project: RUNNYMEDE DPE  
 ENGLEFIELD GREEN DIVISION  
 Drawing: IMPLEMENTED TRAFFIC ORDERS  
 EGHAM

**SURREY COUNTY COUNCIL**

Project No. 3282  
 Contract Sheet No. 3282\_91  
 Drawing No. 3282\_91  
 Rev. D  
 Classification: PROPOSAL

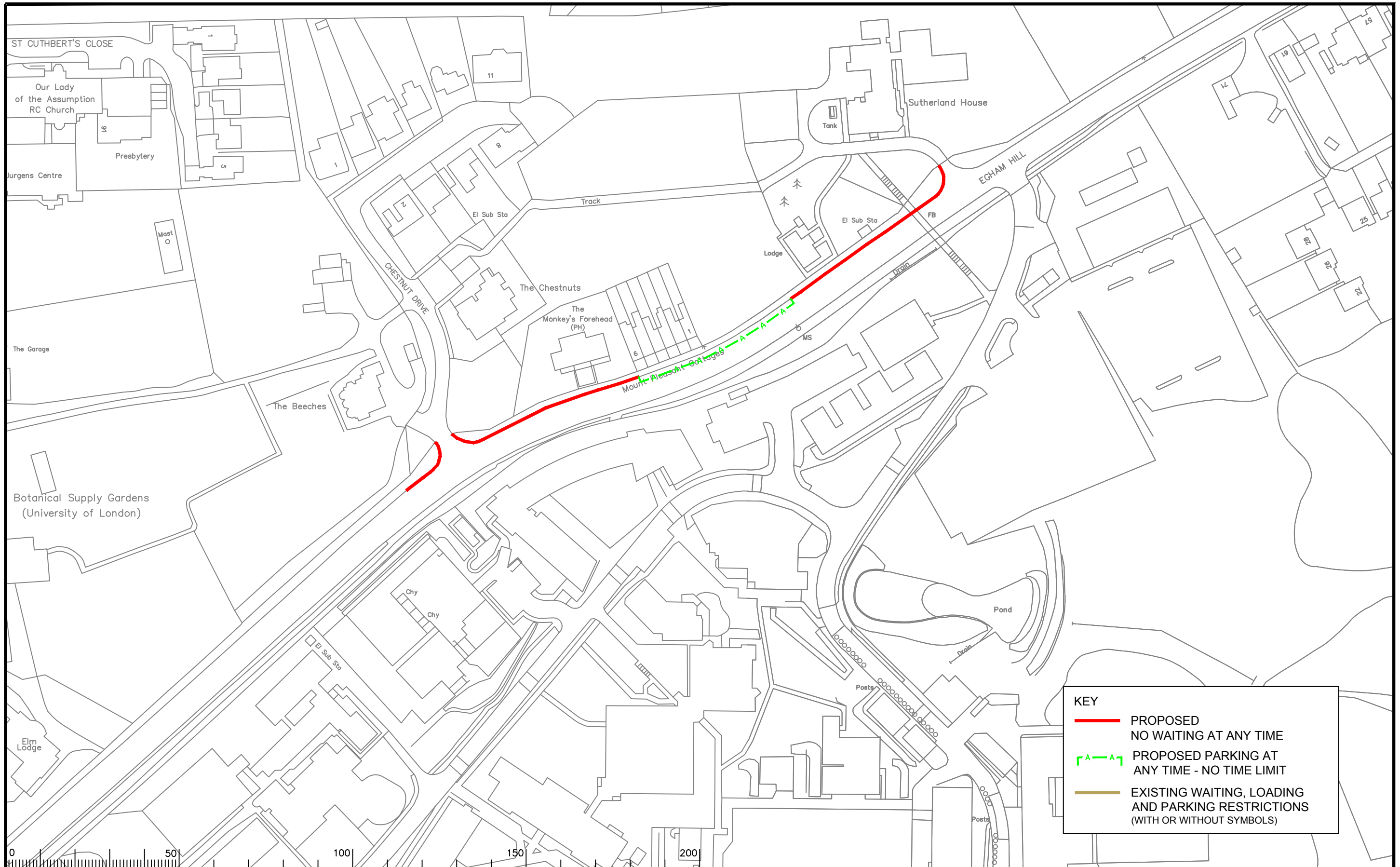

**KEY**

- PROPOSED NO WAITING AT ANY TIME
- - - A - - - PROPOSED PARKING AT ANY TIME - NO TIME LIMIT
- EXISTING WAITING, LOADING AND PARKING RESTRICTIONS (WITH OR WITHOUT SYMBOLS)

Notes

Rev.	Description	Drwn	Sig.	Date	Chkd	Sig.	Date	Appr	Sig.	Date

North Point

Based upon the Ordnance Survey mapping with the permission of the Controller of Her Majesty's Stationery Office © Crown copyright. Unauthorised reproduction infringes Crown copyright and may lead to prosecution or civil proceedings. Surrey County Council LA 076872 1996.

Drawn by	Sig.	Date
CAH	CAH	10.19
Checked by	Sig.	Date
PW	PW	10.19
Approved by	Sig.	Date
DC	DC	10.19

Project  
**RUNNYMEDE DPE**  
**ENGLEFIELD GREEN DIVISION**

Drawing  
**IMPLEMENTED TRAFFIC ORDERS**  
**ENGLEFIELD GREEN**

SHEET OF

Project No. 3282/RUN  
Contract Sheet No. 3282\_110  
Drawing No. 3282\_110  
Rev. -  
Classification PROPOSAL